

General Purpose Pumps



MARINE PRODUCT DATA SHEET

OEM: 8050-305-426

AFTERMARKET: 8050-305-426

Incorporating SHURflo's advance motor technology that includes thermal overload protection, these pumps are self-priming, easy to install and are extremely versatile-perfect for a variety of uses including winterizing, Oil changing and liquid transfer.

TYPICAL APPLICATIONS

Oil change systems. Other uses may include 12 VDC pressurized water systems, winterizing, and liquid transfer. For other applications contact SHURflo.

PUMP

Type: 3 Chamber Diaphragm
 Ports: 3/8" NPT-Female
 Liquid: 130 °F [54 °C] Max
 Prime: 6 feet [1.82 M]
 Inlet PSI: 30 PSI [2.1 Bar] Max
 Run Dry: Yes

ELECTRICAL

Motor: 12VDC Permanent Magnet, Continuous Duty
 Protection: Thermal Overload
 Leads: 8 feet with alligator clips
 Fuse: 7.5 Amp Recommended
 Control: 30 PSI Internal By-Pass (No External Control)

MATERIALS

Housing: Polypropylene
 Valves: Buna
 Diaphragm: Geolast 87 Shore
 Hardware: Stainless Steel

APPROVALS

CE

WARRANTY

1 Year Limited Warranty
 See SB-1041 & SB-1050 For Full Warranty Details

SHIPPING

Net Weight (Boxed): 8 Lb [3.6 Kg] each
 Carton Weight: 1 each, 8 Lb [3.6 Kg]
 Carton Size: 13"L x 13"W x 13"H
 [33 cm x 33 cm x 33 cm]

RELATED DOCUMENTS

Catalog: MS-030-140
 Installation Manual: 911-672
 Maintenance: 911-672
 Applications Spec Guide: MS-020-005
 Warranty: SB-1050

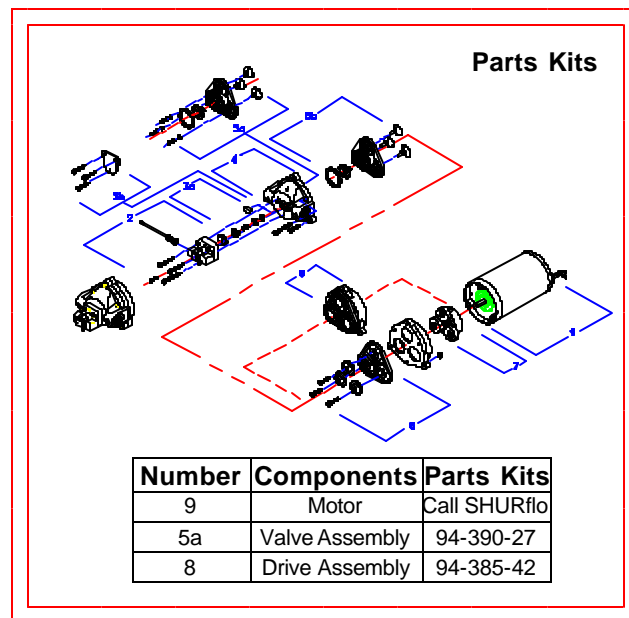

PERFORMANCE @ 12V DC WITH WATER

PRESSURE		FLOW		CURRENT
BAR	PSI	GPM	LPM	AMPS
0.0	0	1.55	5.86	2.2
0.7	10	1.45	5.48	2.8
1.4	20	1.36	5.14	3.5
2.1	30	1.10	4.16	4.1
2.8	40	0.15	0.56	4.4

TYPICAL MOTOR SHELL T-RISE @ 40 PSI, 12V

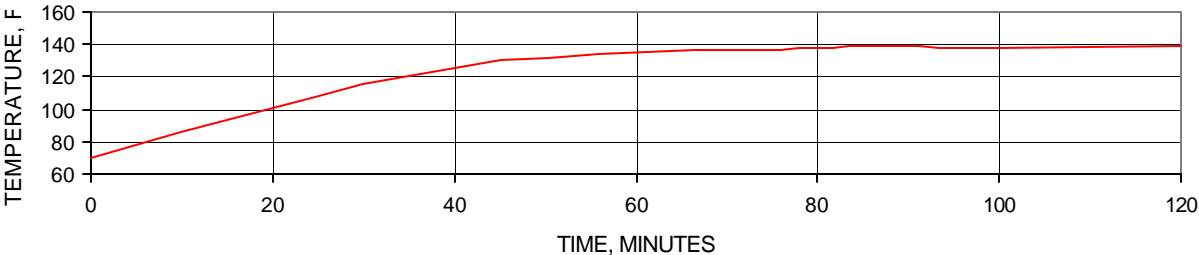

DIMENSIONS [mm]

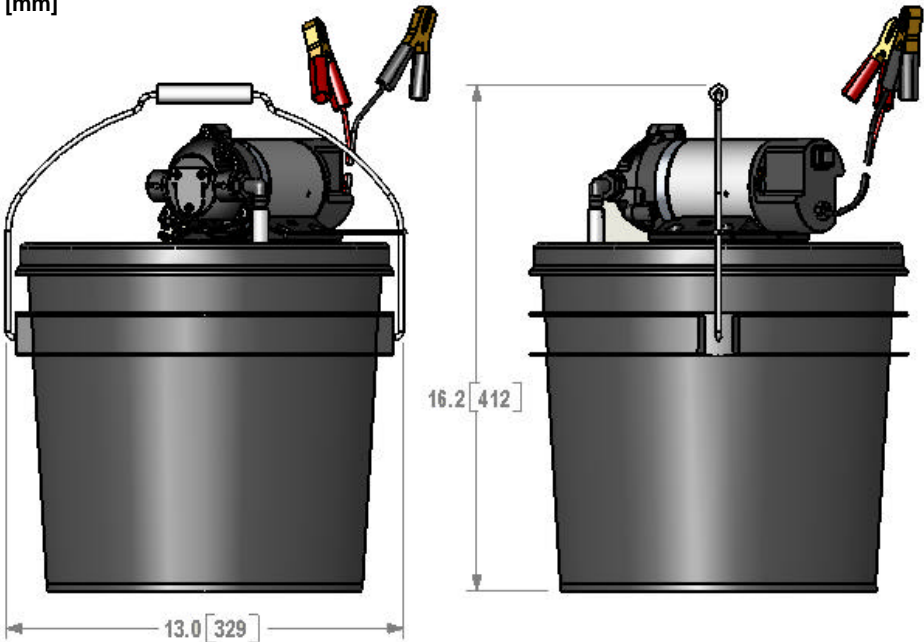

For technical advice or service please take your pump into your local pump service center.

To order pump or parts or for pricing please go to the following links :

[Shurflo Pumps Home >>](#)

[Shurflo Pumps stock list >>](#)