

LittleGIANT®

HI-TEMPERATURE 10E SERIES



Features

- Handles liquids up to 200°F
- Handles liquids and solid waste materials up to 3/4" diameter
- Cast iron pump housing with protective epoxy coating for corrosion and rust resistance
- Oil-filled motor housing for lifetime lubrication and rapid heat dissipation
- Integral mechanical float switch
- Thermal overload protection
- Manual and automatic models
- Automatic operation has 10" to 12" "On" level and 2" to 4" "Off" level range
- All 115 volt models are CSA listed



This high-temperature version of the 10E Sump/Effluent Pump is capable of pumping up to 200°F liquid. Uses include boiler blow-down pits, rendering plant wash-down sump pits, public utility underground transformer vaults, industrial steam cleaning sump pits, etc. Pumps feature a 1-1/2" discharge, with a lift of 24'. Cast iron housing, volute, and relay housing with protective epoxy coating, nylon base and vortex nylon impeller.

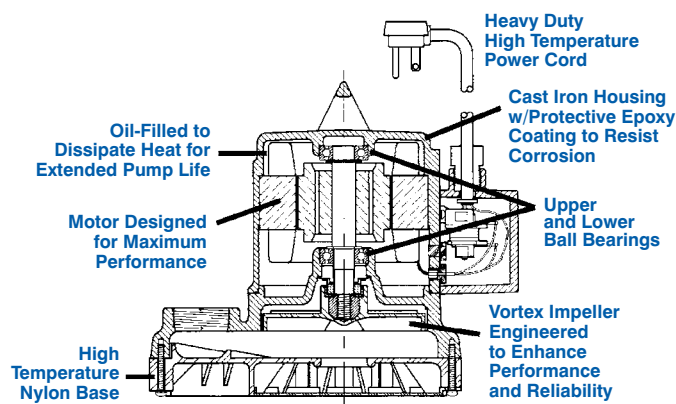

HI-TEMPERATURE 10E SERIES

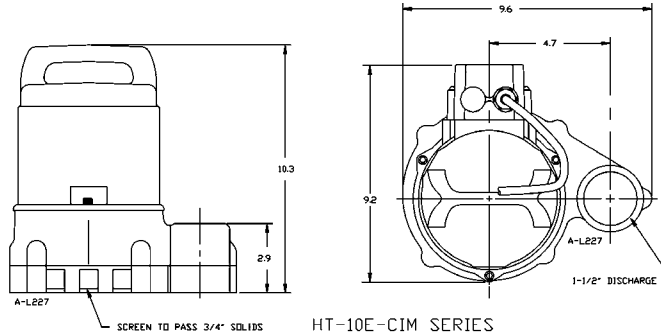
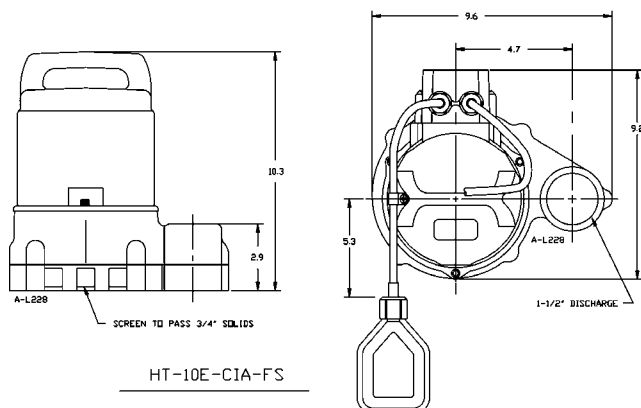

Specifications

Model No.	Item No.	Listing	HP	Volts/Hz	Solids Size (dia. in.)	Running Amps/Watts	Water Temps	Performance (GPM@Head)				Shutoff Ft.	P.S.I.	Cord Length (ft.)	Weight (lbs.)	Dimensions H x L x W (in.)
HT-10E-CIM	511600	CSA	1/2	115/60	3/4	10.5/900	73°F	80	70	59	37	24	10.4	15	38	10.3 x 9.6 x 9.1
							200°F	75	67	52	22	22	9.5			
HT-10E-CIA-FS	511700	CSA	1/2	115/60	3/4	10.5/900	73°F	80	70	59	37	24	10.4	15	38	10.3 x 9.6 x 9.1
							200°F	75	67	52	22	22	9.5			

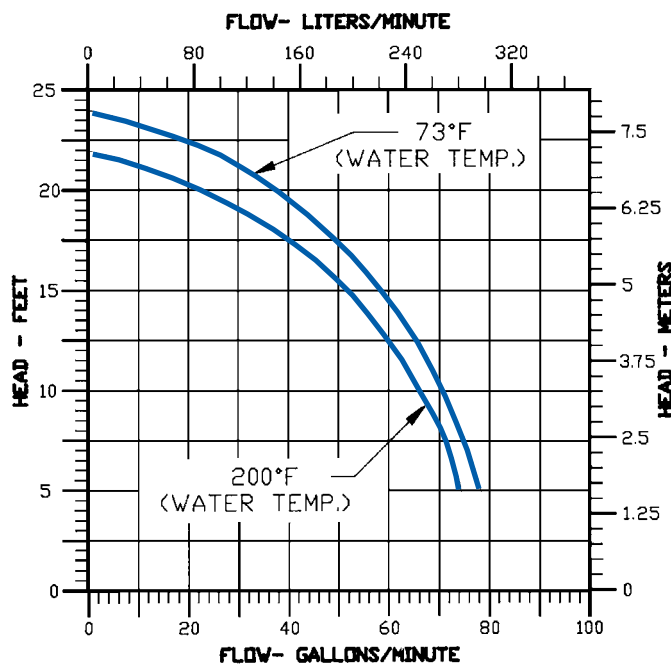

Construction

Motor housing	Epoxy-coated cast iron
Impeller material	Nylon
Impeller type	Vortex
Volute	Epoxy-coated cast iron
Power cord	15' 16-3 SJOW-A, Super Ultron II
Mechanical shaft seal	Viton®, Stainless Steel, Carbon & Ni-Resist Faces
Fasteners	Stainless steel
Shaft	Cold rolled steel
Bearings	Upper and lower ball bearings

Viton® is a registered trademark of DuPont Performance Elastomers