

LittleGIANT®

10 & 12 SERIES



For residential and commercial use, the Model 10 and 12 Series sump pumps provide efficient and reliable service in applications requiring high volume water dispersal. Pumps feature a 1-1/2" discharge with a maximum lift of 23' and 26'. All have cast iron or cast bronze housing and volute. A choice of manual or automatic versions with various switch configurations provides the used the right pump for their needs.

Features

- Cast bronze or cast iron pump housing with protective epoxy coating for corrosion and rust resistance
- Oil-filled motor housing for lifetime lubrication and rapid heat dissipation
- 1/2 HP split phase motor
- Stainless steel fasteners
- Mechanical seal (stainless steel spring, nitrile parts, carbon and ceramic faces)
- Bearings: upper and lower ball bearings for extended motor life
- Thermal overload protection
- Nylon switch housing
- Manual and automatic models
- Automatic operation with pressure switch operates when water level is between 8-1/2" to 12". Pump shuts off when water level falls between 1-1/2" to 5" (pressure switch is non-adjustable).
- UL/CSA listed

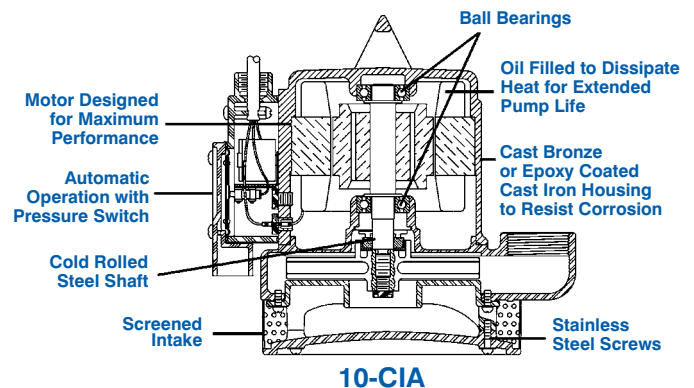

10 & 12 SERIES

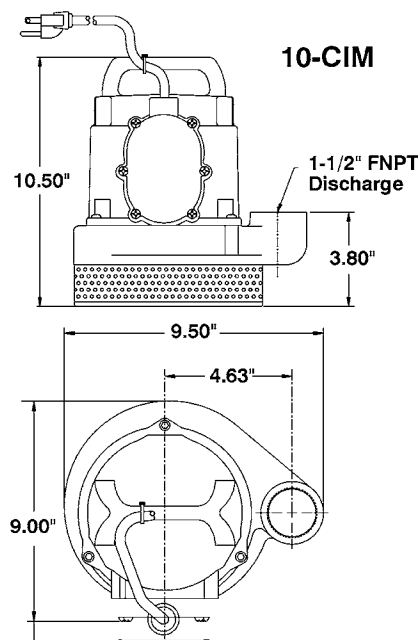
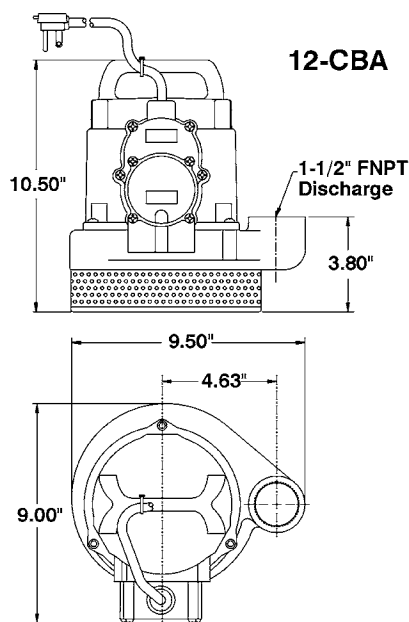

Specifications

Model No.	Item No.	HP	Volts	Running Amps	Watts	Performance (GPM@Head)			Shutoff		Cord Length (ft.)	Dimensions H x L x W (in.)
						5'	10'	15'	Fl.	P.S.I.		
10-CIM	510055	1/2	115	11	1,100	83	63	45	23	10	10	10.5 x 9.3 x 9.5
10-CIA	510155	1/2	115	11	1,100	83	63	45	23	10	10	10.5 x 9.3 x 9.5
10-CIA	510156	1/2	115	11	1,100	83	63	45	23	10	25	10.5 x 9.3 x 9.5
12-CBM	512055	1/2	115	11	1,100	83	66	50	26	11.2	10	10.5 x 8.5 x 9.5
12-CBA	512155	1/2	115	11	1,100	83	66	50	26	11.2	10	10.5 x 8.5 x 9.5
12-CBA	512125	1/2	115	11	1,100	83	66	50	26	11.2	25	10.5 x 8.5 x 9.5

Continuous Duty Rated — "Little Giant Wastewater pumps are rated continuous duty as long as they are run within the published ratings for these pumps."

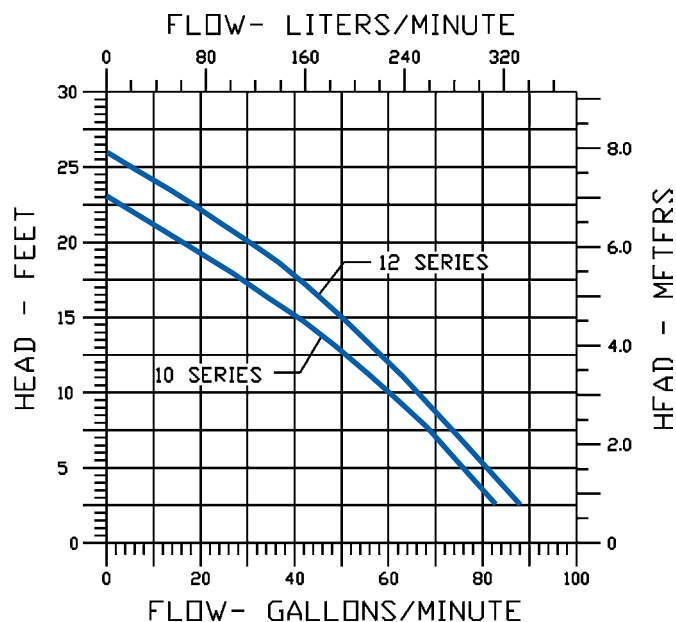

Construction

Motor Housing	Epoxy-coated Cast Iron on #10 Series (cast bronze on #12 Series)
Impeller Material	Nylon
Impeller Type	Non-clog
Volute	Epoxy-coated cast iron on #10 Series (cast bronze on #12 Series)
Power Cord	16-3 SJTW
Mechanical Shaft Seal	Nitrile parts, carbon & ceramic faces
Fasteners	Stainless steel
Shaft	CRS
Bearings	Stainless steel upper & lower ball bearings