

Little **GIANT**®

HI-TEMPERATURE 6E SERIES



Features

- Handles liquids up to 200° F
- 1/2" solids handling capability
- Cast iron pump housing with protective epoxy coating for corrosion resistance
- Oil-filled motor housing for lifetime lubrication and rapid heat dissipation
- Integral mechanical float switch
- Stainless steel screws, bolts and lifting ring to protect against corrosion
- Mechanical seals (stainless steel spring, Carbon and Ni-Resist faces) to assure maximum protection against pump failure
- Bearings: Upper and lower sintered sleeve bearings for extended motor life
- Thermal overload protection
- Automatic operation has 10" to 12" "On" level range



This high temperature version of the 6E Sump/Effluent Pump is capable of pumping heated liquid up to 200°F liquid. Uses include boiler blow-down sump pits, rendering plant wash-down sump pits, public utility underground transformer vaults, industrial steam cleaning sump pits, etc. These pumps handle liquids and solid waste materials up to 1/2" in diameter. Pumps feature a 1-1/2" discharge, with a lift of 20'. Cast iron housing and volute with protective epoxy coating, high-temperature thermoplastic base and vortex nylon impeller.

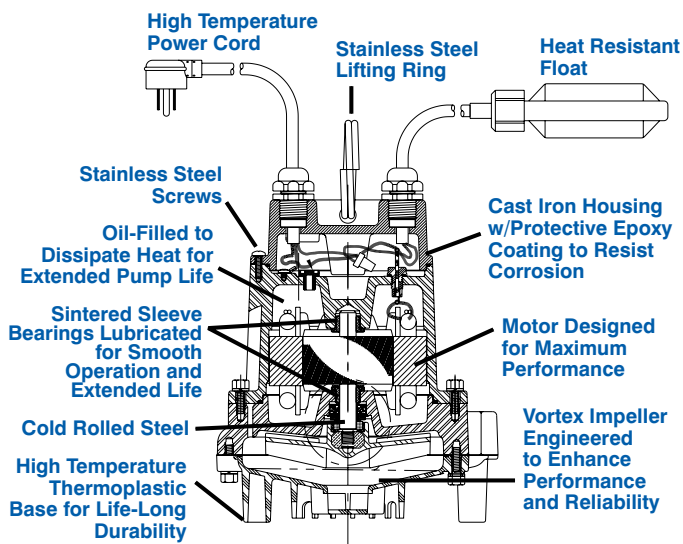

HI-TEMPERATURE 6E SERIES

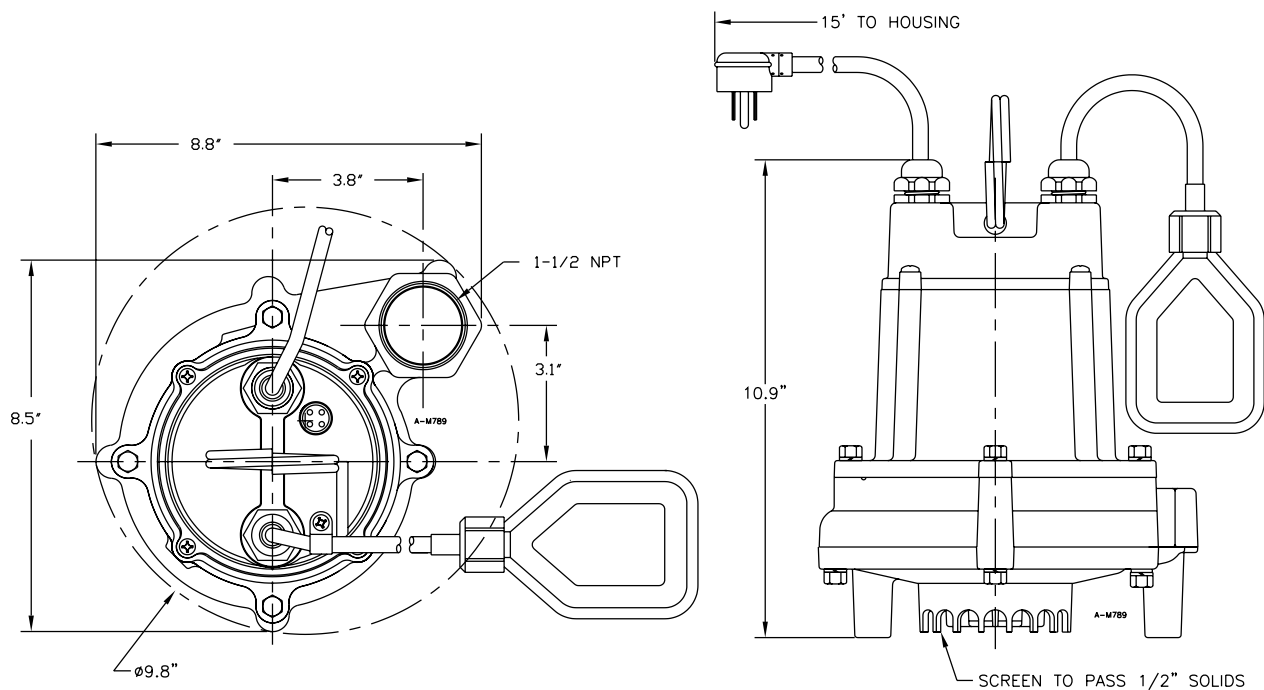

Specifications

Model No.	Item No.	Listing	HP	Volts/Hz	Solids Size (dia. in.)	Running Amps/Watts	Performance (GPM@Head)				Shutoff Ft.	P.S.I.	Cord Length (ft.)	Weight (lbs.)	Dimensions H x L x W (in.)
HT-6E-CIA-FS	506600	CSA	1/3	115/60	1/2"	10.1/735	50	42	27	—	20	8.7	15	32	10.8 x 8.7 x 8.5

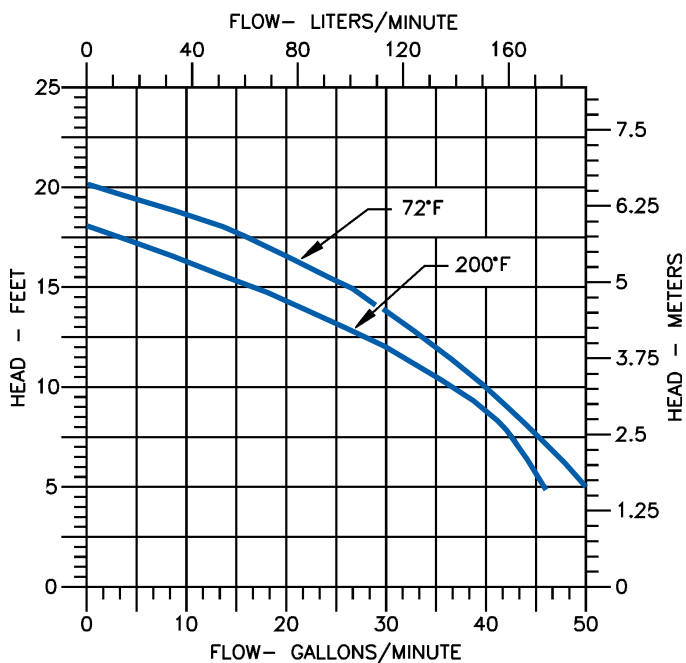

Construction

Motor housing	Epoxy-coated cast iron
Impeller material	Nylon
Impeller type	Vortex
Volute	Epoxy-coated cast iron
Power cord	15' 16-3 SJOW-A, Super Ultron II
Mechanical shaft seal	Stainless Steel, Carbon & Ni-Resist Faces
Fasteners	Stainless steel
Shaft	Cold rolled steel
Bearings	Upper and lower: Oil-impregnated, porous iron/copper, flanged