

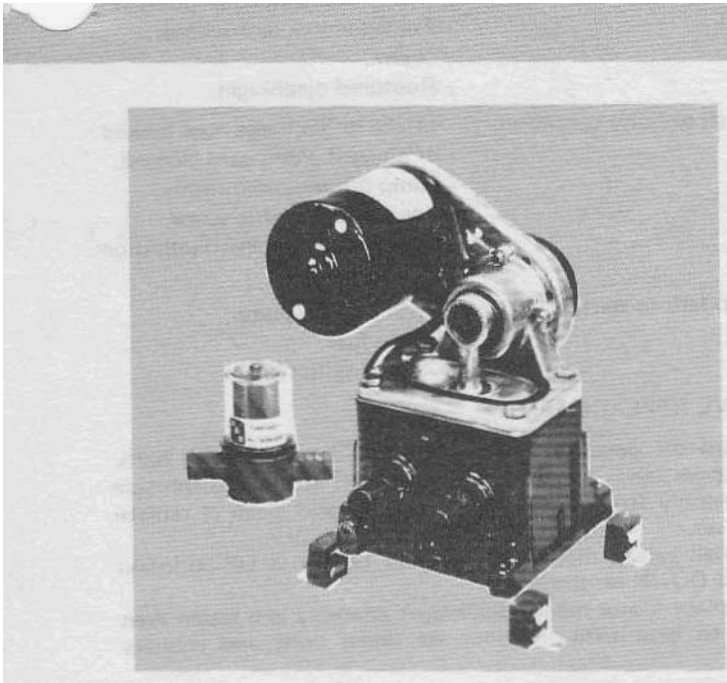

# MODEL 36251-Series

ELECTRIC SHOWER DRAIN PUMP

PRODUCT DATA



## FEATURES

- Self-Priming
- Diaphragm Design Allows Dry Running
- Quiet Operation
- Built-in Hydraulic Pulsation Dampener
- Permanently Lubricated Ball Bearings on Shaft and Connecting Rod
- Corrosion Resistant Materials Throughout for Fresh or Salt Water Service
- Meets USCG Electrical Standards

## SPECIFICATIONS

	U.S. GPM	Liters/Min.	Imp. GPM
Open Flow	2.0	7.5	1.7
Vert. Dry Suction lift:	5 Feet (1.5M)		
Ports:	3/4" Slip-on Hose		
Weight:	8 Lbs. (3.6 kgs.)		

MODEL SERIES

## INSTALLATION

### MOUNTING

Mount upright in a **dry** location (above highest bilge water level) on a solid surface. Adjust belt tension for 1/4 inch play between pulleys.

### PLUMBING

For Intake and discharge use 3/4" 1.0. **non-collapsible hose**. Keep intake and discharge lines free of kinks and restrictions. Install the pumpguard supplied (PAR Model 36200-0000) in the intake line from the sump to protect pump from debris. Use a 3/4" thru-hull fitting (PAR Model 59431-0000) for discharge.

### WIRING

Wire pump in a circuit **independent** of all other electrical fixtures. Use stranded copper wire. Install fuse in positive lead. See table for recommended wire and fuse size. See diagram for **wiring** connections. Use a 10 amp-rated Switch

After installation, It is **recommended** that **voltage** be **checked** at the motor terminals with motor **operating** under full load and all other appliances in the circuit **operating**. Voltage should not be **less** than 90% of rated motor voltage.

## STANDARD MODELS==\_

## MAINTENANCE

**WINTER STORAGE:** When possible it is preferred that the complete pump be removed and stored in a warm dry place. If this is not possible the pump must be completely **drained**, hoses removed and pump **run** until all water is expelled.

## WIRE AND FUSE SIZE

	Model 36251-0000	Model 36251-0010	Model 36251-0020
<b>Wire Length Between Battery and Motor</b>	12 Volt	24 Volt	32 Volt
1.25 feet	14 AWG	14 AWG	16 AWG
25-50 feet	12 AWG	14 AWG	14 AWG
<b>Fuse Size:</b>	5 AMP	4 AMP	2 AMP
	Standard	Standard	Standard

## DIMENSIONAL DRAWING

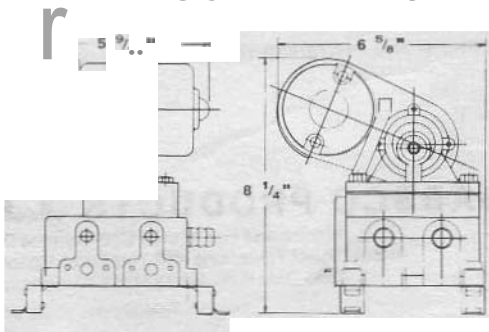

## WIRING DIAGRAM

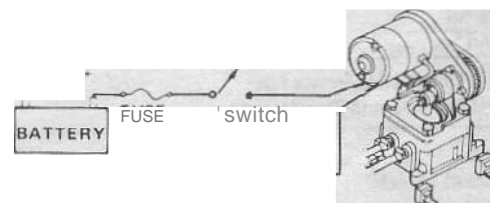

JABSCO PRODUCTS

Form 43000-0342 11-79

SERVICE

EXPLODED VIEW

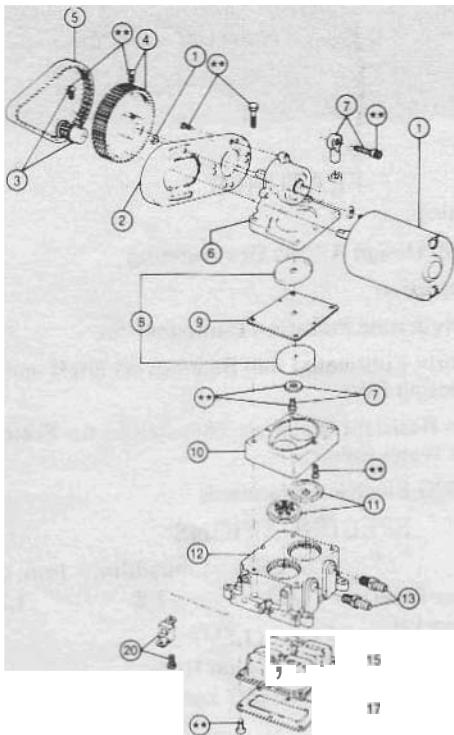

\* Indicates items included in Hardware Kit (Key 21).

PARTS LIST  
36251-Series

Qty	Part Description	Part Number	Qty
1	Motor Kit 12 Volt D.C.	30209-0000	1
1	Motor Kit 24 Volt D.C.	30200-0010	
1	Motor Kit 32 Volt D.C.	30200-0020	
2	Motor Mouldt	34628-0000	1
3	Small Pulley	37169-0000	1
4	Large Pulley	37171-0000	1
5	Belt	30022-0000	1
6	Jack Shaft Assembly	35689-0000	1
1	Connecting Rod Kit	37173-0000	1
8	Diaphragm Plates	35503-0000	2
9	Diaphragm...	30015-0000	1
10	Retainer	35173-0000	1
11	Valve Set (Inlet & Outlet)	30004-0000	1 Set
12	Base Assembly	35620-0000	1
13	Ports (Inlet & Outlet)	37175-0000	1 Set
15	Pulsation Dampener	37118-0000	1
17	Bottom Plate	35686-0000	1
20	Vibration Pad Kit	37180-0000	1 Set
21	Hardware Kit	37166-0000	1 Set
	Service Kit*	30126-0000	

\* Indicates Parts Contained in Service Kit.

† Indicates Parts Supplied with Base Assembly.

Pumpgald	36200-0000
Replacement Screen	36139-0000
"O"-Ring Seal	36403-0000

TROUBLE SHOOTING

Problems	Causes
Loss of suction to pump.	- Air leak in suction line or pumpgald. - No water in sump. - Intake hose kinked or plugged. - Fouled intake or discharge valve. - Ruptured diaphragm.
Rough or noisy operation.	- Intake or discharge hose kinked or plugged. Pumpgald ogged. - Pump not mounted firmly. - Loosened eccentric screw. - Ruptured or collapsed pulsation dampener.
Pump fails to start.	- No voltage to pump. - Blown fuse. - Clogged outlet line.

VALVE REPLACEMENT

1. Turn off power to pump. Remove four tie down bolts.
2. Expose valves by lifting jack shaft and attached diaphragm assembly from pump base. Remove and clean or replace valves.
3. Install valves, making sure rubber flapper is UP on intake and DOWN on discharge.
4. Replace motor-mount-diaphragm assembly and fasten evenly to base with the four tie down bolts and washers.

DIAPHRAGM AND CONNECTING ROD REPLACEMENT

1. Turn off power to pump. Remove four tie down bolts.
2. Lift jack shaft and the attached diaphragm assembly from pump base.
3. Remove (two diaphragm retainer screws and the bottom diaphragm retainer).
4. Remove eccentric screw. Remove connecting rod and diaphragm from the top diaphragm retainer, then unscrew bolt to separate diaphragm and plates.
5. Check diaphragm for cuts and cracks. Check rod assembly bearing for excessive wear. Replace if badly worn.
6. Loosely reassemble diaphragm, diaphragm plates, connecting rod spacer and diaphragm bolt onto connecting rod. Firmly secure connecting rod to jack shaft with the eccentric screw. Secure diaphragm to upper diaphragm retainer with the bottom diaphragm retainer and two screws.
7. Tighten connecting rod bolt.
8. Replace motor-mount-diaphragm assembly and fasten evenly to base with the four tie down bolts and washers.

PULSATION DAMPENER REPLACEMENT

1. Disconnect power leads from pump and remove from mount.
2. Remove nine bottom plate screws and the bottom plate. Pull out and replace pulsation dampener.
3. Replace bottom plate and screws. Tighten evenly to ensure an air and water seal.
4. Reinstall pump and reconnect power leads.

JABSCO PRODUCTS

Marine and Recreation Components Division  
International Telephone and Telegraph Corporation  
1485 Dale Way, Costa Mesa, California 92626

Telephone (714) 545-8251

---

For technical advice or service please take your pump into your local pump service center.  
To order pump or parts or for pricing please go to the following links :

[Jabsco Pumps Home >>](#)

[Jabsco Pumps stock list >>](#)