

MODEL 15210 Series 15230 Series 15250 Series 15270 Series

JABSCO® PUMPS

Pureflo® Sanitary

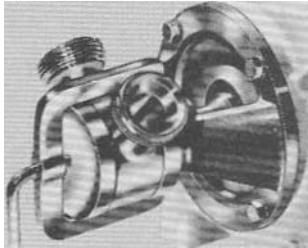

DESIGN FEATURES

- Body: Type 316 **Stainless Steel**
- Impeller: **Jabsc** Neoprene Compound
- Seal: Sanitary Mechanical-Carbon Face
- Ports: 15210-0665 } **1½" Acme Sanitary**
 15230-0665 } **Threads, Ground Seat**
 15250-0665 } **2" Acme Sanitary**
 15270-0665 } **Threads, Ground Selt**
- Motor: Model **15210-0665** Sinituy **¾ HP**
 T.E.N.V., 1150 RPM,
3-Phase, 220/440V B.II
Bearing, Shaft-Type
303 Stainless StHI
- Model 15210-2665 Open Drip Proof **¾ HP**
 115/230V Single Phlse
 1750 RPM Shift-Type
303 Stainless Steel
- Model 15230-0665 Sanitary **2 HP, 1750**
RPM, 3 - Ph1Se,
 220/440V., Bill **Bear-**
ing, Shift-Type
303 Stainless Steel
- Model 15250-0665 **Sanitary - 3 HP, 1160**
 RPM, **3.Ph1S1,**
 220/440V., Bill **Bear-**
ing, Shift-Type **303**
Stainless Steel
- Model 15270-0655 **Sanitary - 3 HP, 1160**
 RPM, **3-Phase 220/440**
 V., Ball Bearing, Shaft-
 Type **303 Stinless**
Steel

Pureflo® Motor Pump Units

VARIATIONS AVAILABLE

| Old Model Number Standard | 10 GPM Single | 15 GPM | 25 GPM | 38 GPM | 74 GPM |
|---|---------------|------------|------------|------------|------------|
| Standard Neoprene Impeller & Clean In Place Ports | S10-1M5 | S10-MS | S25-M5 | S50-M5 | 1 1"HS |
| High Pressure Neoprene Impeller & Acme Ports | 15210-2665 | 15210-0665 | 15230-0665 | 15250-0665 | 15270-0655 |
| High Pressure Neoprene Impeller & CIP Ports | 15210-2765 | 15210-0765 | 15230-0765 | 15250-0765 | 15270-0755 |
| Nitrile Impeller & Acme Port | 15210-2663 | 15210-0663 | 15230-0663 | | |
| Nitrile Impell. & CIP Ports | 15210-2763 | 15210-0763 | 15230-0763 | | |

NOTE: Sanitary Nitrile Impellers are available in the models shown above to handle food products having high oil content.

Weight: Model 15210-0665 54 lbs. (approx.)
 Model 15210-2665 95 lbs. (approx.)
 Model 15230-0665 54 lbs. (approx.)
 Model 15250-0665 110 lbs. (approx.)
 Model 15270-0665 123 lbs. (approx.)

APPLICATIONS AND OPERATING INSTRUCTIONS

Some of the many diverse products handled by Jabasco Pureflo pumps include: DAIRY PROCESSING: Buttermilk, Condensed Milk, Cream, Milk, Eggs, Whey and other assorted dairy products. FOOD PROCESSING: Sugar Liquors, Brines, Calsup, Chocolate, Glaze, Gelatin, Halley, Jams, Jellies, Mayonnaise, Molasses, Mustard, Pickle Relish, Vinegar, Water, Yeast Slurries. BEVERAGE PROCESSING: Alcohols, Beers, Brewery Slop, Cider, Distillery Wort, Extracts, Flavors, Juices, Mash, Soft Drinks, Wines. MISCELLANEOUS: Chemicals, Cosmetics, Pharmaceuticals. Jabasco Pureflo Motor Pump Units will pump fluids to the viscosity range of 500 SSU. Fluids with a higher viscosity

range should be handled with a Pedestal Mount Pureflo Pump operating at reduced speeds.

- INSTALLATION - Pump may be mounted in any position. Pump head rotates 360° to permit desired port location. Intake and discharge ports are determined by the direction of shaft rotation. Looking at end cover with clockwise rotation, inlet port is on horizontal right, with left port vertical.
- SELF-PRIMING - Pump will produce 15 feet of vertical suction lift when dry and 22 feet of lift when wetted. INTAKE LINES MUST BE AIR-TIGHT to prevent product foaming and assure self-priming.

- RUNNING DRY - The impeller is lubricated by the product being pumped. DO NOT RUN DRY for more than 30 seconds. Lack of liquid may damage the impeller.
- TEMPERATURES - 40°-150°F. Contact factory for impeller recommendation on applications outside this range. Other impeller compounds are available which may be utilized for certain applications at higher or lower temperatures.
- PRESSURES - Consult performance chart. When operating pressures approach the upper recommended ranges for standard pressure impellers, it is ordinarily desirable to use a high pressure model to increase impeller life.

EXPLODED VIEW

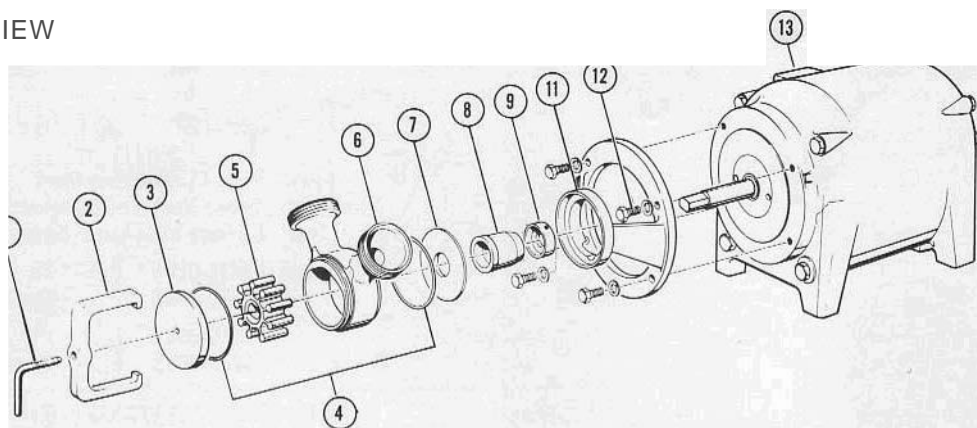

1521 0-Series

| KEY | DESCRIPTION | PART NUMBER | S.i.1 No. 10-AJ 140a thru 10-AJ1551 | | Se.i.1 No. 10-1216 thru IQ-Jt3120 10-41 th., 10-41 9 | | QTY |
|------------|---------------------------------|-------------------|---|--|---|-------------------------------------|-----|
| | | | 6-72 & Subsequent | IQ-A41 thru 10-A99 3-70 thru 5-72 | Se.i.1 No. 10-1216 thru IQ-Jt3120 10-41 th., 10-41 9 | Se.i.1 No. 10-11 thru 10-1215 | |
| 1 | Clamp Screw | 10408-0010 | 10408-0010 | | | | 1 |
| 2 | Clamp | 12695-0000 | 12695-0000 | 12534-0000 | 98018-0020 | | 1 |
| 3 | End Cover | 10435-0001 | 10435-0001 | 9268-0000 | 8253-0000 | | 1 |
| 4* | O Ring (Body) | 92000-0290 | 92000 0290 | 92000-0720 | 92000,0650 | | 2 |
| 5* | Neoprene Imp (Std.1) | 7614-0005 | 7614-0005 | 7614-0005 | 7614,0005 | | 1 |
| | Neoprene Imp (H.P.) | 8980-0005 | 8980-0005 | 8980-0005 | 8980-0005 | | |
| | Nitrile Imp (Std) | 7614-0006 | 7614-0006 | 7614-0006 | 7614-0006 | | |
| | Nitrile Imp (H.P.) | 8980-0006 | 8980-0006 | 8980-0006 | 8980-0006 | | |
| 6 | Body (Acme) | 15014-0061 | 15014-0061 | 9265-0000 | 7564-0000 | | 1 |
| | Body (elPI) | 15014-0071 | 15014-0071 | 9266-0000 | 7564-0010 | | |
| Not Shown | O Ring (ICIP Port) | 92000-0710 | 92000-0710 | 92000-0110 | 92000-0710 | | 2 |
| 7 | Wear Plate | 10396-0010 | 10396-0010 | 9267-0000 | 7806-0000 | | 1 |
| 8* | Seal Assy | 7749-0000 | 7749-0000 | 7749-0000 | 7749-0000 | | 1 |
| 9 | Seal Collar | 5301-0000 | 5307-0000 | 5301-0000 | 5307-0000 | | 1 |
| Not Shown* | Allen Wrench | 92351-0050 | 92351-0050 | 92351-0050 | 92351-0050 | | 1 |
| 11 | Adaptor | 12694-0000 | 12694-0000 | 7565-0000 | 7565-0000 | | 1 |
| 12 | Bolt | 91094-0230 | 91094-0070 | 81106-0040 | 91106-0040 | | 4 |
| | Washer | 91602-0260 | 91602-0090 | 81602-0090 | 91602-0090 | | 4 |
| 13 | Motor 3 Phase 3/4 HP | 93004-1030 | 93004-1030 | 93004-0670 | 93004-0670 | | 1 |
| | Motor Single Phase 3/4 HP | 83004-1020 | 93004-1020 | 83004-0660 | 93004-0660 | | |
| | Service Kit Neoprene (Std.1) | 90072-0005 | 90072-0005 | 90072-0005 | | | |
| | Neoprene (H.P.) | 80073-0005 | 90073-0005 | 90073-0005 | | | |
| | Nitrile (Std.1) | 90072-0003 | 90072-0003 | 90072-0003 | | | |

*Parts supplied in Service Kit

SERVICE INSTRUCTIONS

All Model Pumps

ASSEMBLY AND DISASSEMBLY OF PUMP HEAD

Before using pump it should be disassembled and cleaned to remove any dust and dirt resulting from storage or shipping. Wash parts in standard cleaning solutions approved for handling stainless steel. Thoroughly rinse before reassembly. **DO NOT USE IODINE BASED SANITIZERS** as the iodine attacks the elastomer materials used in the impeller.

All parts have been expertly machined and polished. **HANDLE WITH CARE. DO NOT DROP OR MISHANDLE.**

DISASSEMBLY

1. Remove end cover clamp, end cover and "O" ring.
2. Grasp pump ports and slide pump body and impeller from shaft.
3. Remove "O" ring and then push the impeller from the pump body.
4. Remove wearplate from pump.
5. Slide seal assembly off the shaft. Do not damage the carbon seal face in handling. Do not loosen or remove seal collar, except as noted below.

ASSEMBLY

1. Slide seal assembly onto shaft (carbon face toward pump head).
2. Replace wearplate. **BE SURE THAT FLAT SIDE IS TOWARD PUMP HEAD AND THE SIDE WITH THE RAISED BOSS IS TOWARD CARBON FACE OF SEAL ASSEMBLY.**
3. Lubricate bore of pump body with Orange **Solid Grease** or suitable substitute and then replace **impeller** into pump body by twisting and pushing at same time.
4. Replace two "O" rings on either side of body and install assembly on shaft. (Impeller blades bent under cam should point in opposite direction to operational rotation.)
5. Position end cover and then replace end cover clamp. **CLAMP SHOULD BE HAND TIGHTENED.** Do not use wrench or hammer.

NOTE: The seal collar is set at the factory to provide proper seal compression and should not require further adjustment.

If adjustment is required:

With pump head disassembled, loosen two set screws on seal collar. Replace seal assembly on shaft and then install wearplate in *Reverse Position* with flat side toward seal. While holding wearplate in position against adapter, push seal assembly and seal collar against wearplate and tighten the two set screws in seal collar. Remove wearplate and replace to correct position with raised boss against carbon face of seal before assembling pump. **DO NOT DISASSEMBLE PUMP WITH WEARPLATE IN REVERSE POSITION.**

HEAD CAPACITY TABLES

STANDARD PRESSURE MODELS

| 15210-0665, -0765 -2665, -2765. | | | | 15230,0665, -0765 | | | | 15250-0665, -0765 | | | | 15270-0665, -0755 | | | |
|------------------------------------|--------------|----------|-----|-------------------|--------------|----------|-----|--------------------------|--------------|----------|-----|-------------------|--------------|----------|-----|
| TOTAL HEAD | | 1750 RPM | | TOTAL HEAD | | 1750 RPM | | TOTAL HEAD | | 1160 RPM | | TOTAL HEAD | | 1160 RPM | |
| lbs. per Sq. In. | Ft. of Water | GPM | HIP | lbs. per Sq. In. | Ft. of Water | GPM | HIP | lbs. per Sq. In. | ft. of Water | GPM | HIP | lbs. per Sq. In. | ft. of Water | GPM | HIP |
| 4.3 | 10 | 11.3 | ¾ | 4.3 | 1G | 25.5 | 2 | 4.3 | 1G | 35.2 | 3 | 8.7 | 20 | 74 | 3 |
| 8.7 | 20 | 10.2 | ¾ | 8.7 | 2G | 24.6 | 2 | 8.7 | 20 | 33.8 | 3 | 17.3 | 40 | 62 | 3 |
| 13.0 | 30 | 9.0 | ¾ | 17.3 | 40 | 23.0 | 2 | 17.3 | 40 | 29.4 | 3 | 21.6 | 50 | 54 | 3 |
| 21.6 | 5G | 5.2 | ¾ | 26.0 | 60 | 21.0 | 2 | 26.0 | 60 | 23.2 | 3 | | | | |
| | | | | 34.6 | 80 | 18.0 | 2 | | | | | | | | |

HIGH PRESSURE MODELS

| 15210-0675, -0115 -2675, -2775 | | | | 15230-0675, -0775 | | | | 15250-0675, -0775 | | | |
|-----------------------------------|--------------|----------|-----|-------------------|--------------|----------|-----|-------------------|--------------|----------|-----|
| TOTAL HEAD | | 1750 RPM | | TOTAL HEAD | | 1750 RPM | | TOTAL HEAD | | 1160 RPM | |
| lbs. per Sq. In. | Ft. of Water | GPM | HIP | lbs. per Sq. In. | ft. of Water | GPM | HIP | lbs. per Sq. In. | ft. of Water | GPM | HIP |
| 8.7 | 2G | 10.4 | ¾ | 17.3 | 40 | 22.8 | 2 | 8.7 | 20 | 37.4 | 3 |
| 17.3 | 4G | 8.7 | ¾ | 26.0 | 6G | 21.9 | 2 | 21.6 | 50 | 36.8 | 3 |
| 26.0 | 6G | 6.2 | ¾ | 34.6 | 8G | 20.8 | 2 | 34.6 | 80 | 35.0 | 3 |
| 34.6 | 80 | 4.6 | ¾ | 51.5 | 12G | 17.1 | 2 | 47.6 | 11G | 32.7 | 3 |
| | | | | 60.5 | 14G | 14.2 | 2 | 60.5 | 14G | 28.5 | 3 |

15230-Series

| KEY | DESCRIPTION | Serial No. | | QTY |
|------------|----------------------|-----------------------|--|-----|
| | | 25-A41 and Subsequent | 25-11 thru 25-32370 25-41 thru 25-445 | |
| | | PART NUMBER | PART NUMBER | |
| 1 | Clamp Screw | 9551-0010 | | 1 |
| 2 | Clamp | 12698-0000 | 12533-0000 | 1 |
| 3 | End Cover | 10515-0001 | 8825-0000 | 1 |
| 4 | O Ring 180dyl | 92000-0310 | 92000-0690 | 2 |
| 5 | Neoprene Imp. (Std.) | 8981-0005 | 8981-0005 | 1 |
| | Neoprene Imp. (HT) | 8840-0005 | 8840-0005 | |
| | Nitrile Imp (Std) | 8840-0006 | 8840-0006 | |
| 6 | Body (Acme) | 15034-0061 | 8608.Q000 | 1 |
| | Body (CIP) | 15034-0071 | 8808-0000 | |
| HOI Shown | O Ring (CIP Port) | 92000-0710 | 92000-0110 | 2 |
| 7 | Wear PIT | 10046-0010 | 8806-0000 | 1 |
| | Seal Assy | 8728-0000 | 8728-0000 | 1 |
| 8 | Seal Collar | 8727-0000 | 8727-0000 | 1 |
| No. Shown: | Allen Wrench | 92351-0050 | 92351-0050 | 1 |
| 11 | Adaptor | 14034-0000 | | |
| 12 | Bolt | 91094-0070 | 91106-0040 | 0 |
| | Washer | 91602-0090 | 91602-0090 | ● |
| 13 | Motor (2 HP) | 93004-1010 | 93004-0680 | 1 |
| | Service Kit | | | |
| | Neoprene (Std.) | 90089-0005 | 90089-0005 | |
| | Neoprene (HP) | 90090-0005 | 90090-0005 | |
| | Nitrile (Std.) | 90090-0006 | 90090-0006 | |

* Parts supplied in Service Kit

15250-series

| KEY | DESCRIPTION | Serial No. | | | QTY |
|------------|----------------------|-----------------------|--|-------------------|-----|
| | | 50-A41 and Subsequent | 50-251 thru 50-32610 50-41 thru 50445 | 50-11 thru 50-250 | |
| | | PART NUMBER | PART NUMBER | PART NUMBER | |
| 1 | Clamp Screw | 10697-0010 | | | 1 |
| 2 | Clamp | 129960000 | 12058-0000 | 98018-0080 | 1 |
| 3 | End Cover | 10299-0001 | 12056-0000 | 120560000 | 1 |
| 4 | O Ring (Body) | 92000-0040 | 92000-0740 | 92000-0700 | 2 |
| 5 | Neoprene Imp (S,d,l) | 14346-0005 | 14346-0005 | 14346-0005 | 1 |
| | Neoprene Imp. (H.P.) | 8983-0005 | 8983-0005 | 8983-0005 | |
| 6 | Body (Acme) | 15054-0061 | 8994-0000 | 8994-0000 | 1 |
| | Body (CIP) | 15054-0071 | 12024-0000 | 12024-0000 | |
| NOI Shown | O Ring (CIP Port) | 92000-0130 | 92000-0730 | 92000-0730 | 2 |
| 7 | Wear PIT | 10276-0010 | 8896-0000 | 8896-0000 | 1 |
| | Seal Assy | 9023-0000 | 9023-0000 | 9023-0000 | 1 |
| 8 | Seal Collar | 1866-0000 | 1866-0000 | 7866-0000 | 1 |
| No. Shown: | Allen Wrench | 92351-0050 | 92351-0050 | 92351-0050 | 1 |
| 11 | Adaptor | 14094-0000 | 8894-0000 | 8894-0000 | 1 |
| 12 | Bol, | 91094-0070 | 91106-0040 | 91106-0040 | ● |
| | Washer | 91602,0090 | 91602-0090 | 91602-0090 | ● |
| 13 | Motor (3 Hpi) | 93004-1680 | 93004-0690 | 93004-0690 | 1 |
| | Service Kit | | | | |
| | Neoprene (Std.) | 90093-0005 | 90093-0005 | | |
| | Neoprene (Hp,l) | 90094-0005 | 90094-0005 | | |

* Parts supplied in Service Kit

15270-Series

| KEY | DESCRIPTION | PART NUMBER | Serial No. | Serial No. | Serial No. | QTY |
|------------|--------------------------------|-------------|--------------------------------|---|------------------------|-----|
| | | | thru 100-A99 3-10 thru 1-10 | 1110-3198 thru 100-33180 any 100-41 thru 483 | 100-1 thru 100-3197 | |
| 1 | Clamp Screw | 10354-0010 | 10354-0010 | | | 1 |
| 2 | Clamp | 12927-0000 | 12927-0000 | 12197-0000 | | 1 |
| 3 | End Cover | 10345-0001 | 10345-0001 | 12531-0000 | 8965-0000 | 1 |
| 0" | II Ring (Body) | 92000-0030 | 92000-0030 | 92000-0630 | 92000-0630 | 2 |
| III | Neoprene Imp. (Std.) | 8963-0005 | 8984-0005 | 8984-0005 | 8984-0005 | 1 |
| ● | Body (Acme) | 15074-0061 | 150140061 | 7994-0000 | 7994-0000 | 1 |
| | Body (CIP) | 15074-0071 | 15014-0011 | 12014-0000 | 12014-0000 | 1 |
| Not Shown | a Ring (CIP Port) | 92000-0730 | 92000-0730 | 92000-0730 | 92000-0730 | 2 |
| 7 | Wear Plate | 10346-0010 | 10346-0010 | 7096-11000 | 10960000 | 1 |
| II | Seal Assy | 14052-0000 | 14052-0000 | 14052-0000 | 14052-0000 | 1 |
| 7 | Seal Collar | 8248-0000 | 8248-0000 | 8241-0000 | 8241-0000 | 1 |
| Not Shown* | Allen Wrench | 92351-0050 | 92351-0050 | 92351-0050 | 92351-0050 | 1 |
| 11 | Adaptor | 14104-0000 | 14104-0000 | 8964-0000 | 8964-0000 | 1 |
| 12 | goly | 91094-0070 | 91094-0070 | 91106-0040 | 91106-0040 | ● |
| | Washer | 91602-0090 | 91602-0090 | 91602-0090 | 91602-0090 | ● |
| 13 | Motor (3 HP) | 93004 1690 | 93004 1080 | 93004-0690 | 93004-0690 | 1 |
| | Service Kit Neoprene (Std.) | 90080-0035 | 90080-0025 | 90080-0025 | 90080-0025 | |

NOTE: Product viscosity to 500 S.S.U. may be handled by Pureflo motor pumps with 1750 RPM motors.
 Product viscosity to 6000 S.S.U. may be handled by Pureno motor pumps with 1160 RPM motors.

EXPLANATION OF SERIAL NUMBERS:

- Effective March 30, 1970, the Serial Number consists of Month and Year of Manufacture, e.g. 5-70 - May, 1970.
- Prior to March 30, 1970:

The first part of the serial number denotes the capacity of the pump. For example, serial number 100-3021 was used on a 100 GPM pump. The first number in the second series of digits denotes the year the pump was manufactured. For example, serial number 100-3021 reveals the pump was produced in 1963. The use of this digit is VERY IMPORTANT. A pump bearing the serial number 100-401 is a "later" number than serial number 100-3021. Pumps with serial numbers containing the letter "A" are of most recent design except as noted in 1 above.

JABSCO PRODUCTS 

A Unit of International Telephone and Telegraph Corporation, 1485 Dale Way, Costa Mesa, California 92626
 Telephone; (714) 545-8251

For technical advice or service please take your pump into your local pump service center.
To order pump or parts or for pricing please go to the following links :

[Jabsco Pumps Home >>](#)

[Jabsco Pumps stock list >>](#)