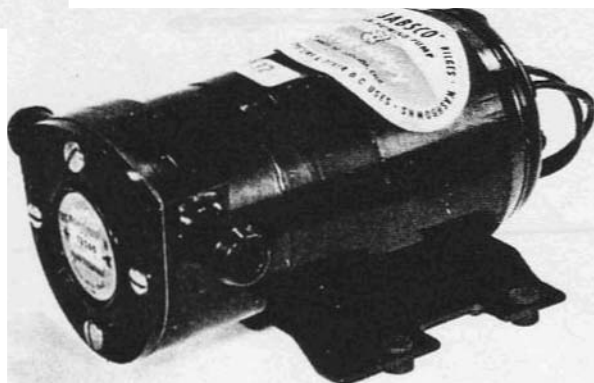

MODELS:

12550-0001 6v., D.C. 12570-0001 24v., D.C.

12560-0001 12v., D.C. 12580-0001 32v., D.C.

Product Data**PLASTIC "Water Puppy"****Self-Priming
Motor Pump Unit**

The pump body is made of tough phenolic-type plastic which will not flow or distort under heat . . . withstands high temperature sometimes caused by dry running.

Jabsco pumps should not be run dry for more than two minutes or the impeller and seal may be damaged.

JABSCO'S FAMOUS LONG-LIVED IMPELLERS

- Jabsco's "Nitrile" Impeller will handle sea water, oily bilge water, most diesel fuels, petroleum based lubricating oil and kerosene. More than 20 years' of research and development have produced these tough, dependable, long-lived impellers.

Ideal for Bilge Pumping, Bail Tank, Wash Down.

Available in Jabsco Manual Bilge Kits.

For larger boats, a variety of higher capacity Jabsco Bilge Pumps are available.

DESIGN FEATURES:

Pump	Corrosion resistant materials used throughout. Easy to disassemble for inspection and service.
BODY	Phenolic-type plastic
IMPELLER	Jabsco "Nitrile" Compound
SHAFT	Stainless steel
WEAR PLATES	Stainless steel
PORTS	for $\frac{3}{8}$ " 1.0. hose
WEIGHT	5¼ pounds (approximately)
MOTOR	6, 12, 24, 32 volt, D.C., 1/15 hp, motor. Stainless steel shaft.

ENJOY THESE OPERATING BENEFITS!

- Ample capacity - delivers 5.4 GPM at 10 foot head.
- Will not air lock or vapor lock if liquid flow is temporarily interrupted.
- Will not clog or jam with foreign solid matter which will pass through pipe, hose or port opening.
- No gears to wear, jam or lubricate . . . flexible impeller resists wear or any jamming action . . . is lubricated by the liquid being pumped.
- Easy to service - impeller or seal replacement can be accomplished quickly and easily - without special tools.
- No metal-to-metal contact - pump not susceptible to rapid wear. If wear should occur, wearing surfaces are quickly, easily and inexpensively replaced.
- Dependable - long years of trouble-free service when properly applied.

JABSCO PRODUCTS

PumpAgents.com - buy pumps and parts online

f. 1294-A Rev. V11

MODELS12550-0001
12570-0001

24V 6V

D.C.

2560-0000
2580-0000

12V 32V

D.C.

EXPLODED VIEW

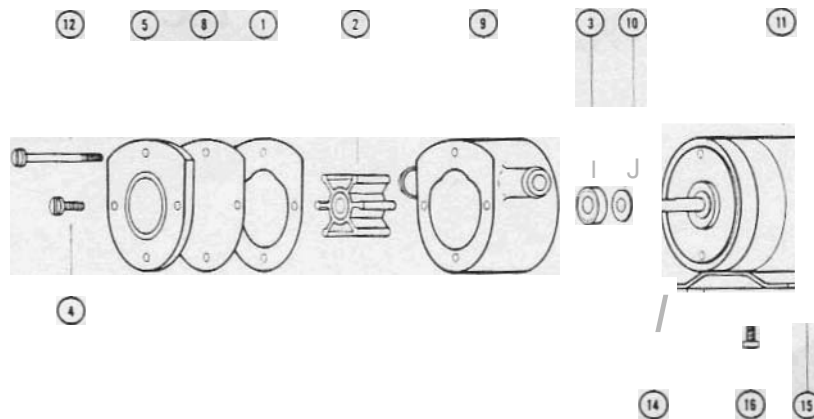

PARTS LIST

Qty	Description	Qty. Req.	Part Number
1	Gasket	1	12558-0000
2	Impeller	1	6303-0003
3	Seal	1	927DO.Q910 — —
4	Screw fEnd Cover)	2	91014-0020 — —
5	End Cover	1	12555-0000
8	Wearplate	1	12557-0000
7	Body	1	12554-0000
10	Shaft	1	6342-0000
11	Motor	1	
	6 volt		98012-0010
	12 volt		98012-0020
	24volt		98012-0030
	32 volt		98012-0040
12	Screw fMotor Bd 1	2	91014-01010
14	Base	1	6357-0020
15	Grommet	4	92900-0120
16	Screw fBase)	2	91053-0120
	Replacement Pump Head only		12590-0001
	Service Kit		90126-0003

HEAD CAPACITY TABLE

IBS. PER SQ. IN.	FT. OF WATER	GPM
4.3	10	5.4
8.7	20	4.0
13.0	30	1.9

MINIMUM WIRE SIZES

Connection Length	12550 -0001	12560 -0001	12570 -0001	12580 -0001
BetwIn Battery end MOLO,	6 V.	12 V.	24 V.	32 V.
1-10 ft.	#8	#14	#16	#16
11-20 ft.	#6	#12	#16	#16
21-30 ft.	Not Rec.	#10	#12	#16

AMPERE DRAW

Model	12550 -000 6 V.	12560 -0001 12 V.	12570 -0001 24 V.
Amp. Draw (Approx.)	14	7	4
Fuse Size	15	9	5

CAUTION: Use only **multi-strand** copper wire in size recommended. DO NOT use ordinary lamp cord or other substitutes.

JABSCO PRODUCTS

Fluid Handling Division, International Telephone and Telegraph Corporation, 1485 Dale Way, Costa Mesa, Calif

For technical advice or service please take your pump into your local pump service center.
To order pump or parts or for pricing please go to the following links :

[Jabsco Pumps Home >>](#)

[Jabsco Pumps stock list >>](#)