

Little GIANT[®] Pump Company

VCL-45 SERIES



Features

- Vertical type pump unit
- Leakproof, rustproof, ABS tank
- ABS switch cover and pump stand
- Galvanized steel tank cover
- Stainless Steel motor shaft
- 3/8" O.D. Copper tube discharge
- Safety Switch included
- 45' shut-off head
- UL/CSA listed
- Thermal overload protected

Construction

- Motor — 1/5 HP
- Intermittent Liquid Temp. up to — 120° F
- Discharge — 3/8" O.D.
- Housing — N/A
- Cover — Galvanized steel
- Volute — ABS
- Impeller — Polypropylene
- Shaft Seal — N/A
- Screen — ABS

Large, 1 gallon, ABS plastic tank condensate unit. Pumps feature a vertical-type pump with stainless steel motor shaft and galvanized steel tank cover. Discharge is a 3/8" O.D. copper tube. Pump features a safety switch that can be connected to

Little Giant Pump Co.

VCL-45 SERIES

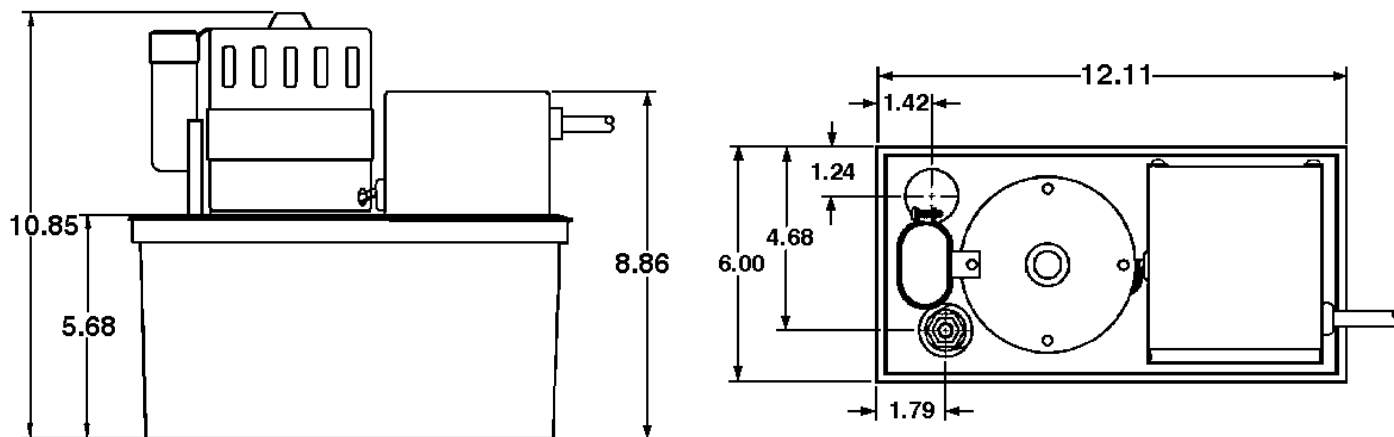

Specifications

Model No.	Item No.	Discharge		HP	Volts	Hertz	Amps	Watts	1'	Performance (GPH @ Head)				Shut Off		Pwr. Cord (ft)	Weight (Lbs.)
		Size	Listing(s)							3'	5'	9'	15'	Feet	PSI		
VCL-45ULS	553240	3/8" OD Copper	UL/CSA	1/5	115	60	3.5	185	450	445	440	415	380	45	19.5	6	13.00
VCL-45ULS	553245	3/8" OD Copper	UL/CSA	1/5	230	50/60	1.0	250	450	445	440	415	380	45	19.5	6	14.00

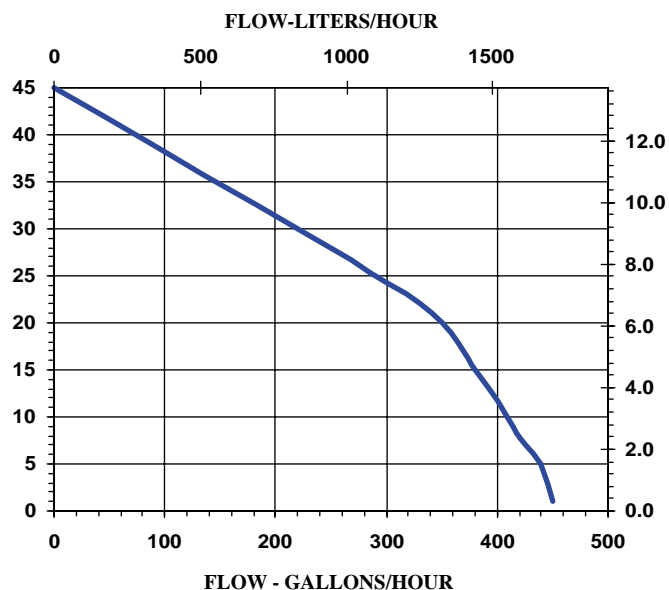

Replacement Parts

Tank	153502
Cover, Tank	153225
Motor Assy	977451
Copper Tubing	938108
Adapter, Brass	941014
Float/Switch Assy	153537
Cover, Switch	153120
Safety Switch Assy	154713
Stand/Volute Assy	153516
Seal Ring	928025
Impeller	153520

For technical advice or service please take your pump into your local pump service center.

To order pump or parts or for pricing please go to the following links :

[Little Giant Pumps Home >>](#)

[Little Giant Pumps stock list >>](#)