

Little **GIANT** Pump Company®

**Eliminator Series
Sump/Effluent Pumps**

9E SERIES



Features

- Handles liquids and solid waste materials up to 3/4" diameter.
- Cast iron pump housing with protective epoxy coating for corrosion resistance
- Oil-filled motor housing for lifetime lubrication and rapid heat dissipation
- Stainless steel screws, bolts and handle
- Mechanical seals (stainless steel spring, nitrile parts, carbon and ceramic faces)
- Bearings: Lower-Ball Bearing
- Thermal overload protection
- Manual and Automatic models
- Automatic operation has 9 to 14 "On" level and 2 to 6 "Off" level range with integral remote float switch.
- All 115 volt models are UL/CSA listed.

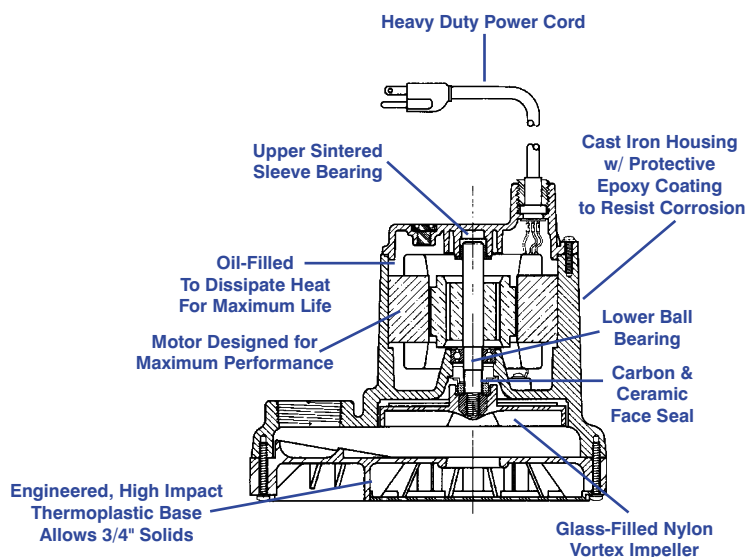

Little Giant Pump Co.

9E SERIES SUMP/EFFLUENT PUMP

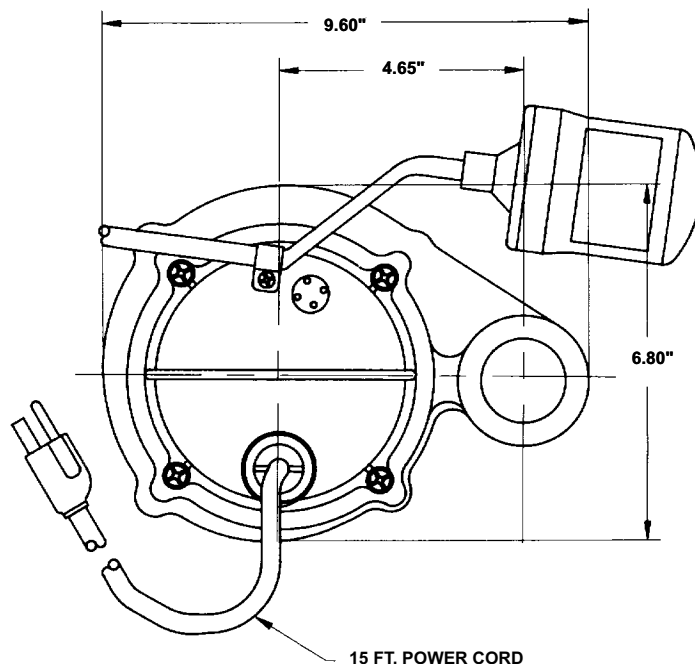
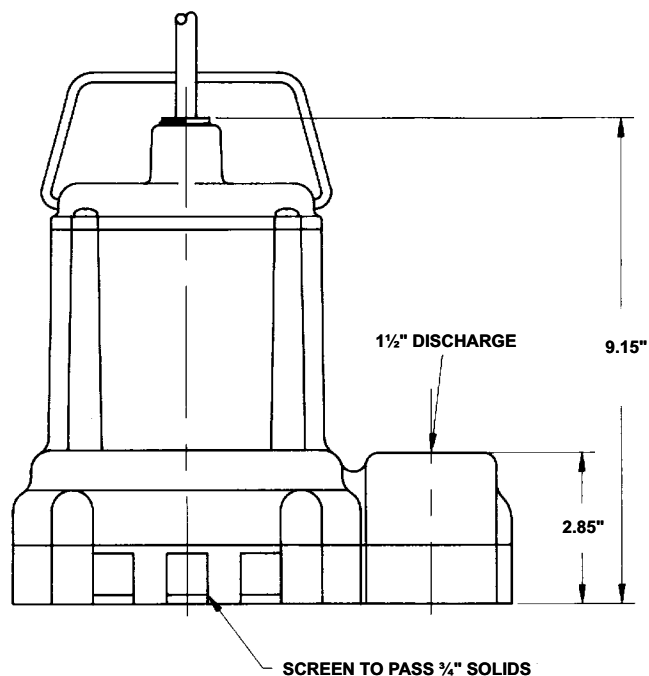

Specifications

MODEL NO.	ITEM NO.	LISTING	HP	VOLTS	SOLIDS SIZE (Dia. In.)	RUNNING AMPS/WATTS	PERFORMANCE (GPM @ HEAD)				SHUTOFF (Ft.)	PS.I.	PWR. CRD. (Ft.)	WEIGHT (Lbs.)	DIMENSIONS (H x L x W in.)
9E-CIM	509200	UL/CSA	4/10	115	3/4	12.3/1000	57	53	40	15	23	10	15	26	9.15 x 9.6 x 6.8
9E-CIA-RFS	509300	UL/CSA	4/10	115	3/4	12.3/1000	57	53	40	15	23	10	15	27	9.15 x 9.6 x 6.8
9E-CIM	509250	—	4/10	230	3/4	6.2/1000	57	53	40	15	23	10	15*	26	9.15 x 9.6 x 6.8
9E-CIA-RFS	509320	UL/CSA	4/10	115	3/4	12.3/1000	57	53	40	15	23	10	20	28	9.15 x 9.6 x 6.8
9E-CIM	509225	UL/CSA	4/10	115	3/4	12.3/1000	57	53	40	15	27	10	25	26	9.15 x 9.6 x 6.8

* w/out plug

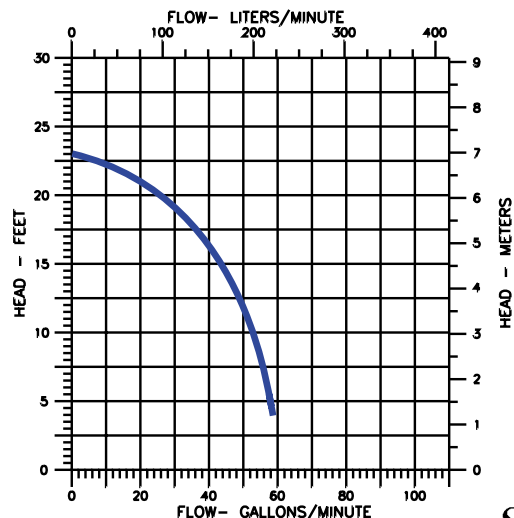

Construction

Cover	Nylon
Motor Housing	Epoxy Coated Cast Iron
Impeller Material	Nylon
Impeller Type	Vortex
Volute	Epoxy Coated Cast Iron
Power Cord	SJTW-A
Mechanical Shaft Seal	Nitrile with carbon and ceramic faces
Fasteners	Stainless Steel
Shaft	Steel
Bearings	Upper Sleeve and Lower Ball Bearings

For technical advice or service please take your pump into your local pump service center.

To order pump or parts or for pricing please go to the following links :

[Little Giant Pumps Home >>](#)

[Little Giant Pumps stock list >>](#)