

JABSCO® PUMPS
Self-Priming Pumps

MODELS:

8850-0001 - 6 v., 8870-0001 - 24 v.
8860-0001 - 12 v., 8880-0001 - 32 v.

Product Data

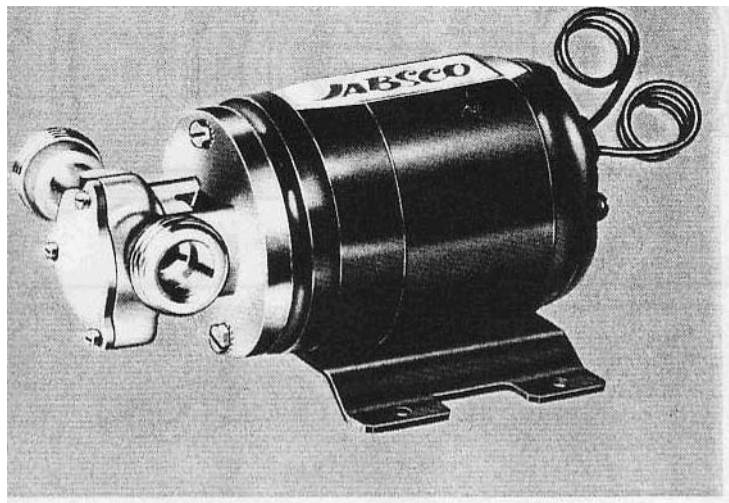

"MINI-PUPPY"

DESIGN FEATURES

- Body: Bronze
- Impeller: **Jabsco** Nitrile Compound
- Seal: Lip Type
- Ports: 3/8" Pipe Thread Internal
3/4" Garden Hose External
- Motor: 1 1/2 H.P., Enclosed
Stainless Steel Shaft
- Weight: 5 1/2 lbs. (approx.)
- Dimensions: 3" High, 6 3/8" Long, 4" Wide

APPLICATIONS AND OPERATING INSTRUCTIONS

Ideal for Bilge Pumping, Bait Tank Wash Down.

1. **INSTALLATION** - Pump may be mounted in any position without loss of efficiency, however, it is suggested that the pump head be down if vertical mounting is desired. DC motor turns clockwise looking at pump end cover, intake port is on the right, discharge left.
2. **WIRING** - Use stranded wire. DO NOT use lamp cord or other substitute. Consult wire size table at right for proper wire size.
3. **SELF-PRIMING** - Pump will produce a suction lift approaching 10 ft. when dry and a lift to 20 feet when primed. BE SURE SUCTION LINES ARE AIR TIGHT.
4. **RUNNING DRY** - Unit depends on liquid pumped for lubrication. DO NOT RUN DRY for more than 30 seconds. Lack of liquid will burn the impeller.
5. **CAUTION** - Do not pump solvents, thinners, or gasoline. If corrosive fluids must be handled, pump life will be prolonged if flushed with water after each use or after each work day. MOTOR IS NOT EXPLOSION PROOF
6. **PRESSURES** — For normal operation, pressure should not exceed 20 feet of head.

7. **TEMPERATURES** - Impeller supplied in pump is recommended for liquid temperatures of 45° - 160°.
8. **FREEZING WEATHER** - Drain unit by loosening end cover plate.
9. **SPARE PARTS** - Avoid costly shut down by always having a 90092-0003 Service Kit on hand.

NOTE: Motor will APPEAR to be running hot. The NORMAL operating temperature is 180°.

MINIMUM WIRE SIZES

Connection Length Between Battery and Motor	8850- 0001 6 V.	8860- 0001 12 V.	8870- 0001 24 V.	8880- 0001 32 V.
1-10 ft.	#8	#14	#16	#16
11-20 ft.	#6	#12	#16	#16
21-30 ft.	N.A. Rec.	#10	#14	#16

CAUTION: Use only wire size recommended above. DO NOT use ordinary lamp cord or other substitute!

AMPERE DRAW

Model	8850- 0001 6 V.	8860- 0001 12 V.	8870- 0001 24 V.	8880- 0001 32 V.
Amp. Draw (Approx.)	10	5	2 1/2	1
Recommended Fuse Size	15	9	5	5

Models: 8850-0001 - 6 v. 8870-0001 - 24 v. 8860-0001 - 12 v. 8880-0001 - 32 v.

JABSCO PRODUCTS

EXPLODED VIEW

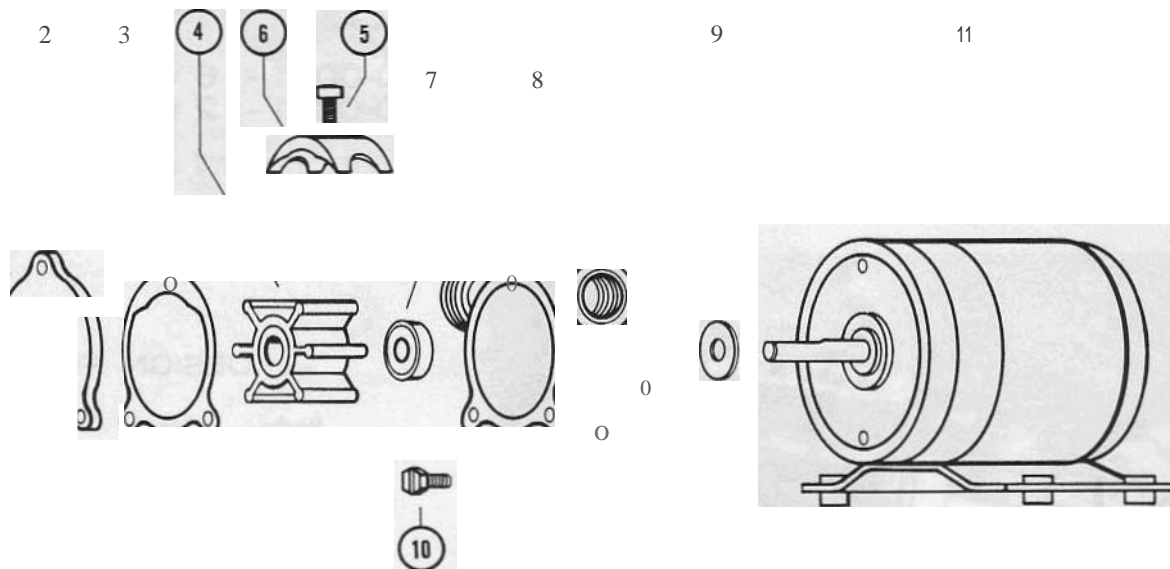

PARTS LIST

PART NUMBER	DESCRIPTION	REQ. QTY.
91002-0090	Screw (End Cover)	3
1855-0000	End Cover	1
8865-0000	Model 8850-0001	
8875-0000	Model 8860-0001	
1885-0000	Model 8870-0001	
7828-0000	Gasket	1
1414-0003	Impeller	1
91002-0010	Screw (Cem)	1
8089-0000	Seal	1
93000-0100	Body	1
7824-0000	Body	1
6342-0000	Slinger	1
98019-0060	Screw (Body to Mo'to.)	1
98012-0010	MoIO	1
98012-0020	Model 8850-0001 6	
98012-0030	Model 8a60-0001 12	
9a012-o040	Model 1170-0001 24	
9040-0001	Model a880.0001 32	
90092.0003	Replace... Pump Head Service Kit	

Part supplied in Service Kit

HEAD CAPACITY TABLE

lin. pe Sq. Ft.	Ft. of Water	GPM
4.3	10	2.4
11	20	1.0
13.0	30	0.7
17.3	40	1.7

Table shows approximate Head-Flow for new pump in U.S. gillions per minute

SERVICE INSTRUCTIONS

DISASSEMBLY

1. Remove screws, end cover and gasket.
 2. Withdraw impeller.
 3. Loosen and remove two slotted hex screws, which attach body to motor.
 4. Tap body lightly between ports and remove body from motor.
 5. Deform seal and remove from body cavity.
- NOTE: Do not tamper with or disassemble motor.

ASSEMBLY

1. Lubricate seal. Deform seal and install in cavity with open side of seal facing impeller.
2. Lubricate motor shaft and install body on motor.
3. Lubricate impeller bore and aligning ding in impeller with flat on motor shaft, install impeller.
4. Install gasket, end cover and screws.

JABSCO PRODUCTS

Fluid Handling Division. International Telephone and Telegraph Corporation, 1485 Dale Way, Costa Mesa, California 92626

For technical advice or service please take your pump into your local pump service center.
To order pump or parts or for pricing please go to the following links :

[Jabsco Pumps Home >>](#)

[Jabsco Pumps stock list >>](#)