



Model 35115-0020

FLANGE MOUNT 3" BLOWER

FEATURES

- Tough Reinforced Plastic Housing
- Mount To Any Surface
- Slip-On Inlet Ducting Connection
- Excellent High Volume Airflow
- Low Current Draw
- Corrosion-Resistant Materials Throughout
- NEMA Type Accepted
- Meets Requirements of Title 33, Chapter I, Part 183, Subpart 1, USCG Electrical Regulations

SPECIFICATIONS

OPEN AIRFLOW: 105 CFM
(2.9 m³/min)

VOLTAGE: 12 Vdc

AMPERAGE: 4.4 Amps

FUSE SIZE: 6Amps

WEIGHT: 4 lb (2.3 kg)

Jabsco blowers are primarily intended for intermittent duty cycles such as evacuating fuel vapors from bilge areas. If desired, they also may be used for other general air circulation applications with longer duty cycles. However, when doing so, it should be noted that the maximum motor life is approximately 1000 hours. Therefore, the blower should only be used for applications if this length of service is acceptable.

INSTALLATION

INSTALLATIONS MUST MEET APPLICABLE SECTIONS OF TITLE 33, PART 183; SUBPART K, USCG VENTILATION REGULATIONS.

MOUNTING: Mount blower on flat bulkhead surface in highest part of compartment free from spray or deck wash. If mounting blower in a location where spray into discharge pipe may occur, mount blower with motor in a vertical orientation as shown in installation drawing. Cut a 2-3/4" hole in bulkhead and secure blower with washers and No. 10 screws. (NOTE: Tighten screws evenly to avoid flange damage.) Use outlet collar NO. 34855-0000 to connect ducting to discharge vent. Use a suitable discharge fitting so that static pressure of blower will not be affected by change in wind direction. Route inlet ducting with as few bends as possible to lower 1/3 of the bilge compartment where vapors are likely to accumulate. Be sure ducting is positioned below top of engine stringers but not so low as to become submerged in bilge water. Locate pickup to take advantage of natural air flow direction. Jabsco flexible ducting No. 34959-0100 is easy to cut and install.

NOTE: Blower should be mounted away from extreme heat (more than 131°F) to prevent distortion of blower wheel or housing.

Jabsco ventilator intake screen No. 34764-0000 provides a safe and attractive protected inlet. NOTE: This blower may also be mounted with inlet through bulkhead, using intake collar No. 34943-0000.

WIRING: Use stranded copper wire. For lengths up to 25 feet (7.6m) from power source: Use 16 gauge wire for runs up to 25 feet and 14 gauge for runs of 25 to 40 feet. Use larger wire for longer lengths. Use a 10 amp rated on-off switch in positive side of circuit (Jabsco Model 44960-0002 or 44960-0003). Circuit must be protected with a fuse. Suggested fuse sizes are listed in the specification table.



Model 35115-0020

OPERATION: See following warning placard statement



Explosion hazard. Gasoline vapors can explode. Before starting engine, operate blower for 4 minutes and check engine compartment bilge for gasoline vapors. Run blower below cruising speed. Failure to do so can result in injury or death.

THE "WARNING" PLACARD (OR EQUIVALENT) SUPPLIED WITH BLOWER MUST BE MOUNTED ADJACENT TO ENGINE IGNITION SWITCHES (ALL LOCATIONS) TO COMPLY WITH TITLE 33, PART 183, SUBPART K, USCG VENTILATION REGULATIONS.

Additional warning placards are available from factory by requesting form 43003-0418

INSTALLATION DRAWING

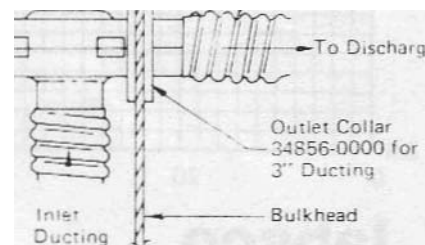

PARTS LIST

rAATS VIEW

Key	Part Description	35115-0020	Qty.
1	Motor K,t 12 Vdc	35145-0010*	1
2	Blower Housing	35678-0000	1
3	Blower Wheel	34742-0001	1
4	Blower Housing	35679-0000	1
5	Screw 8 x 5/8 5S Self Tapping Pan Head	35508-0000	4

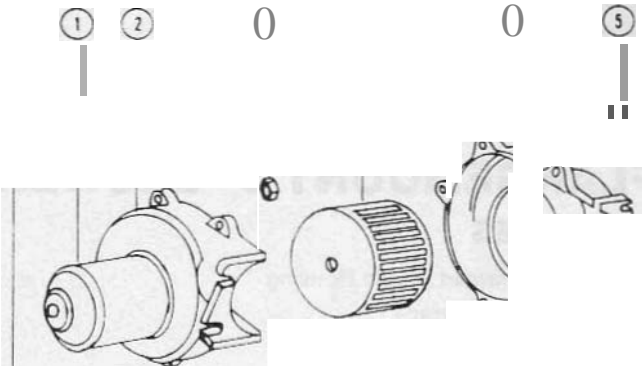

"Motor nuts not included. Order (2) 34681-0000 nut.

DIMENSIONAL DRAWING
INCHES (MILLIMETRES)

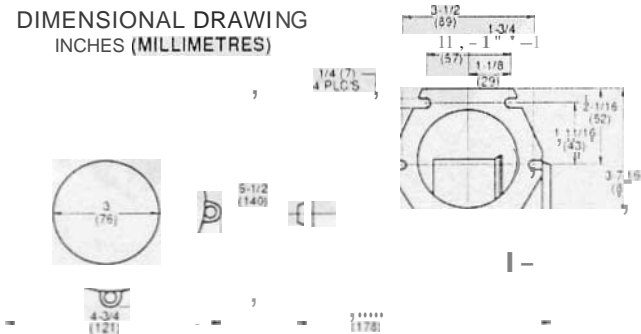

MARINE SWITCH PANELS

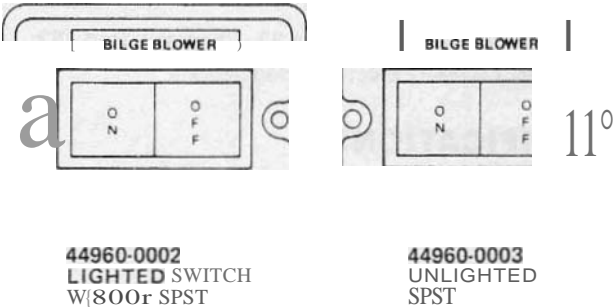

MODEL 35115-0020
12 VDC

AIRFLOW VS AMPERES

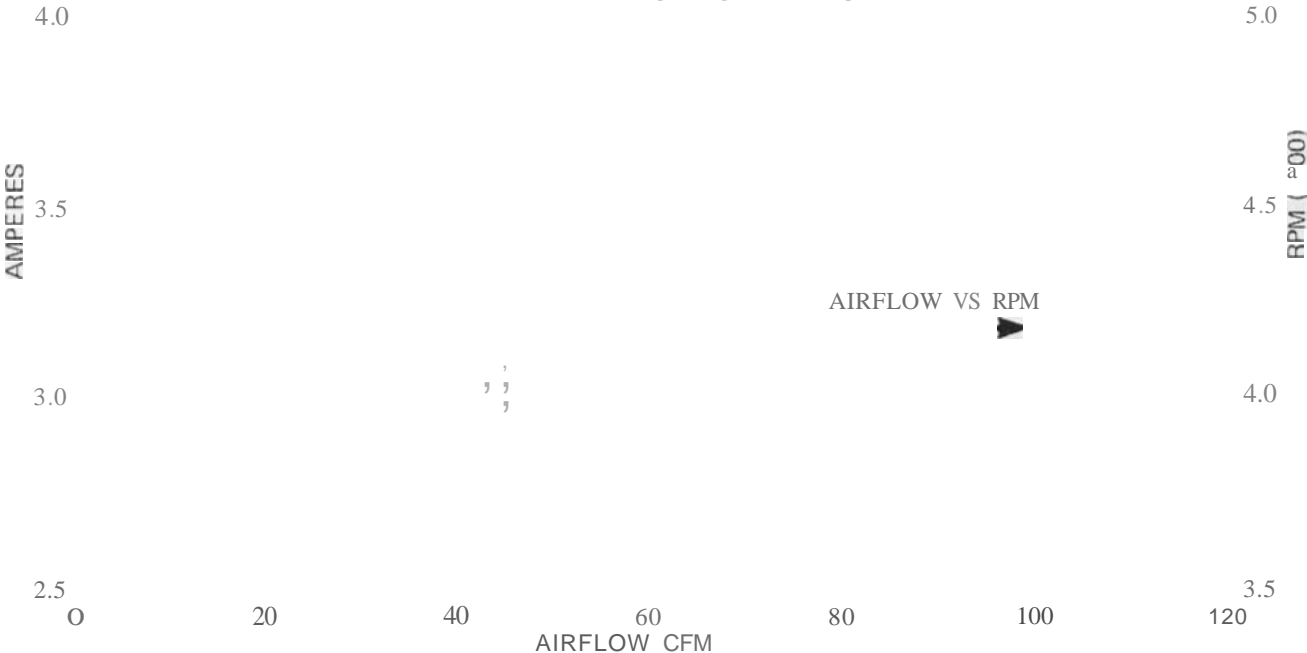

ITT Jabsco

A Unit of In Fluid Technology Corporation

U.S.A.
In Jabsco
1405 Dale Way, P.O. Box 2158

UNITED KINGDOM
Pump Agents Ltd.
Ringley Road, Hoddeston

CANADA
Pump Agents Ltd.
55 Royal Road

JAPAN
Pump Agents Ltd.
3-21-10, Shin-Yokohama



GERMANY
MINTEC GmbH
Oststrasse 28

For technical advice or service please take your pump into your local pump service center.
To order pump or parts or for pricing please go to the following links :

[Jabsco Pumps Home >>](#)

[Jabsco Pumps stock list >>](#)