



Model 34739-Series

Model 34739-Series

FLANGEMOUNT 3" BLOWER

FEATURES

- Tough Reinforced Plastic Housing
- Mount to Any Flat Surface
- Slip-On Inlet Dueling Connection
- Efficient High Volume Air Flow
- Low-Current Draw
- Corrosion-Resistant Materials Throughout
- N.M.M.A. Type Accepted
- Meets USCG Electrical Regulations of Title 33, Chapter I, Part 183; Subpart I and ISO 8846 MARINE for Ignition Protection.
- DC Models Comply with ISO 9097 Marine
- (E DC Models Conform with EN 50081-1 for Suppression of Electromagnetic Interference

SPECIFICATIONS

| Model | Air Flow | Voltage | Amps | Fuse Size | Weight Jb(kg) |
|------------|---------------------------------------|---------|------|---------------|---------------|
| 34739-0010 | 150 CFM (4.0 m ³ /min.) | 12 Vdc | 6.5 | 10A | 5 (2.3) |
| 34739-0020 | 150 CFM (4.2 m ³ /min.) | 24 Vdc | 3.3 | 5A | 5 (2.3) |
| 34739-0031 | 150 CFM (4.0m ³ /min.) | 115Vdc | 0.8 | 1.25A 125V | 5 (2.3) |

WIRING FOR DC MODELS: Use stranded copper wire. For lengths up to 25 feet (7.6m) from power source: Use 12 gauge wire for 12 Volt and 14 gauge wire for 24 Volt. Use larger wire for longer lengths. Use a 10 amp rated on-off switch in positive side of circuit (Model 44960-0003). Circuit must be protected with a fuse. Suggested fuse sizes are listed in the specifications table.

WIRING FOR AC MODEL: Use 16 gauge stranded copper wire for lengths up to 100 feet from power source. Connect the grounded, unswitched conductor (white) to the white motor lead. Connect the underground, switched conductor (black) to the black motor lead. This conductor should include, at the power source, a 1.25 amp 125 Volt fuse. The green motor lead must be connected to the AC circuit ground.

INSTALLATION

INSTALLATIONS MUST MEET APPLICABLE SECTIONS OF TITLE 33, PART 183; SUBPART K, USCG VENTILATION REGULATIONS.

MOUNTING: Mount blower on flat bulkhead surface in highest part of compartment free from spray or deck wash. Cut 2-3/4" hole in bulkhead and secure blower with washers and No. 10 screws.

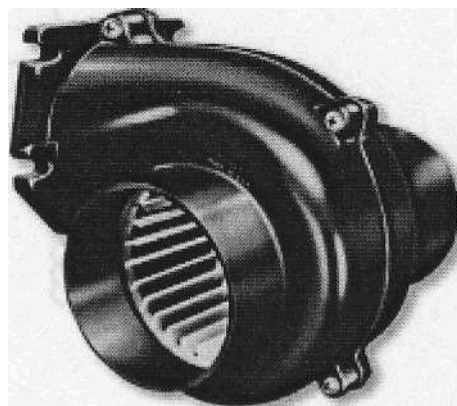

Explosion hazard. Gasoline vapors can explode. Before starting engine, operate blower for 4 minutes and check engine compartment bilge for gasoline vapors. Run blower below cruising speed. Failure to do so can result in injury or death.

The "WARNING" placard supplied with blower must be mounted adjacent to engine ignition switches (all Locations) to comply with Title 33, Part 1834; Subpart K, USCG Ventilation Regulations.*

*Additional warning placards are available from factory by requesting form 43003-0418.

INSTALLATION ORAWING

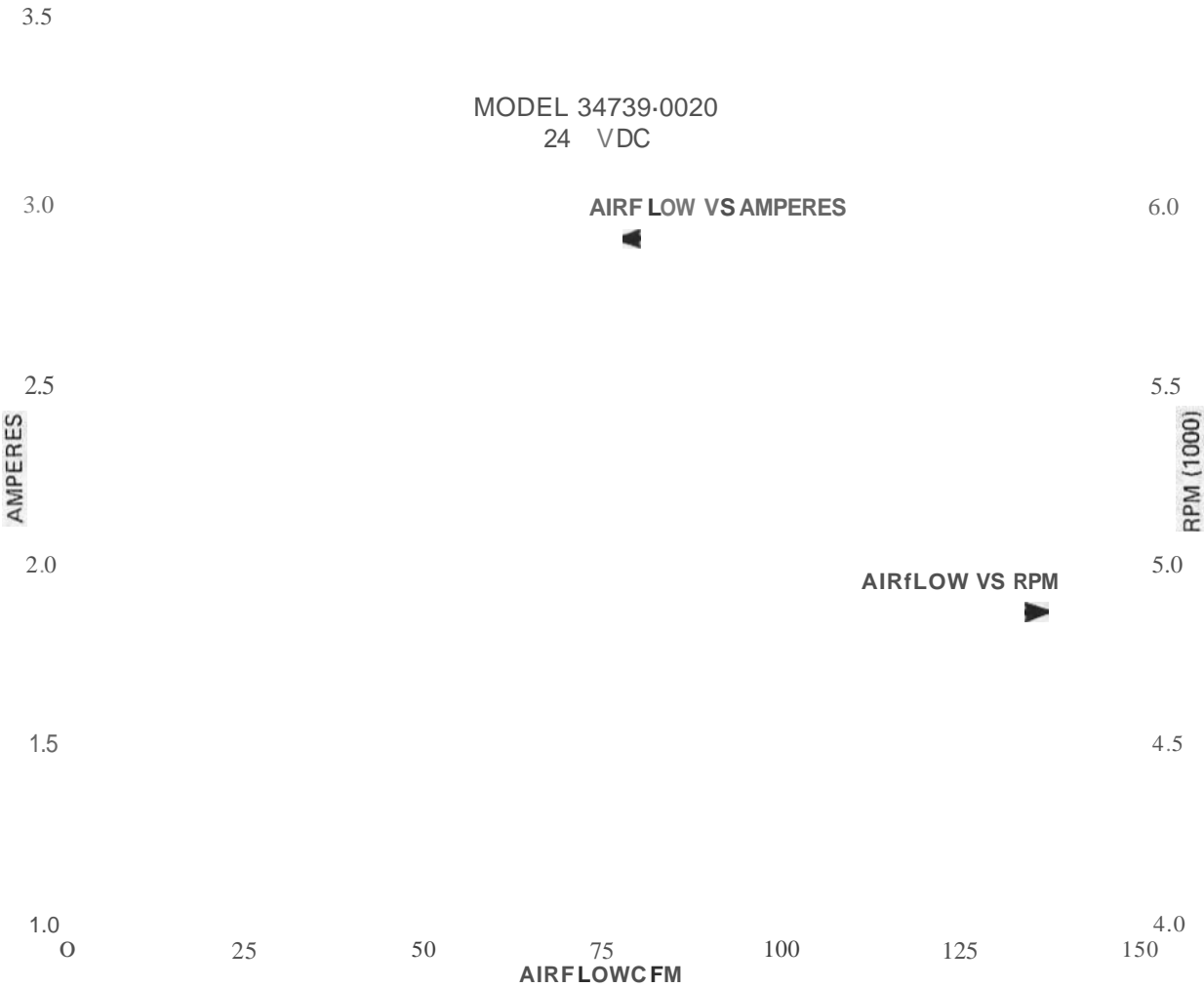
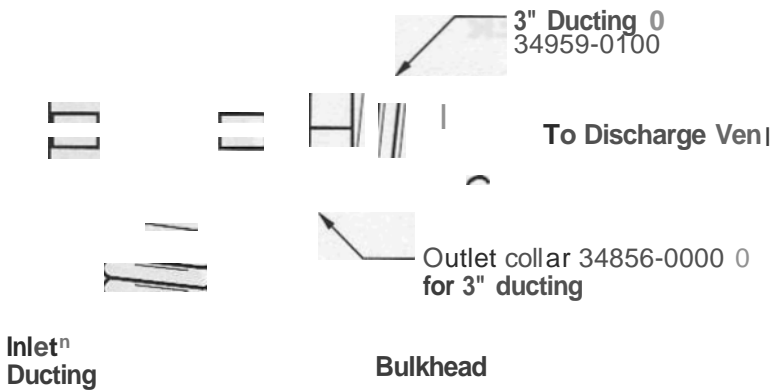

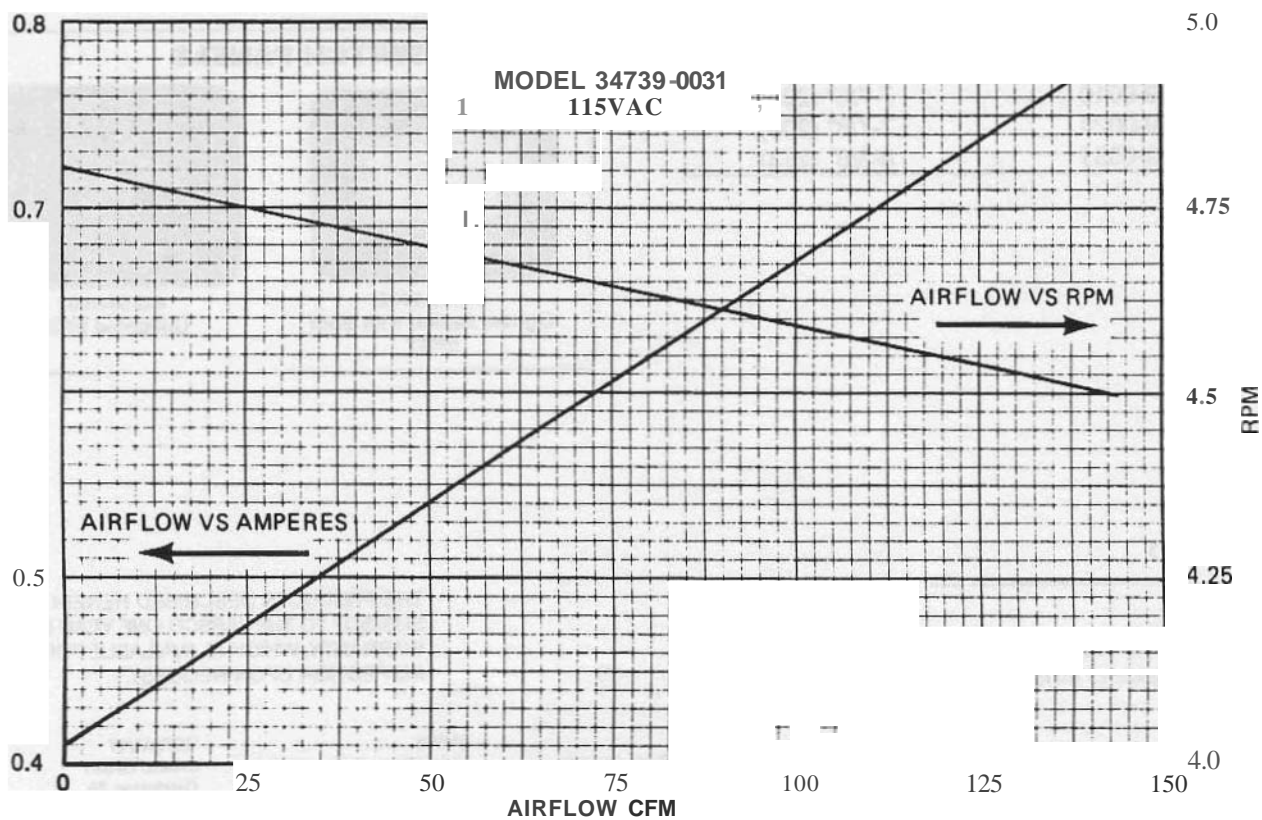
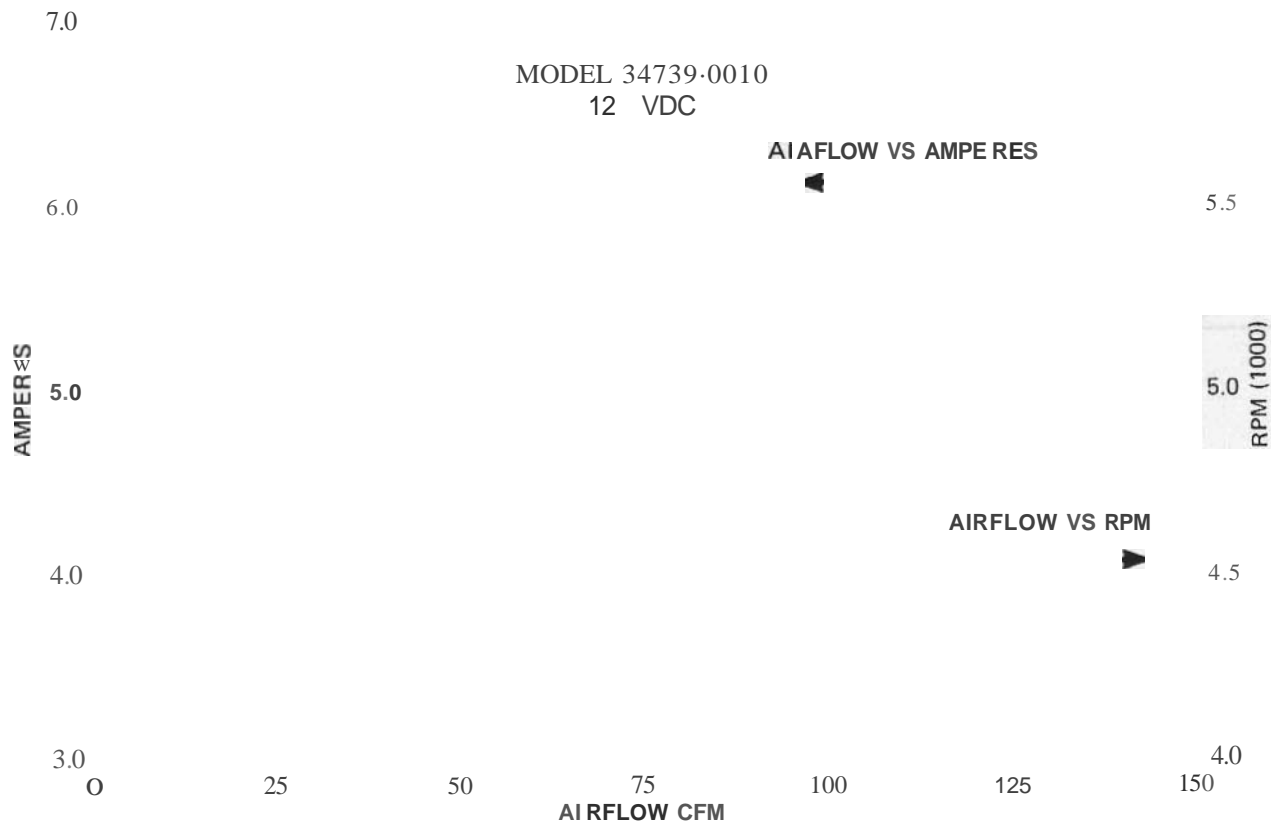

| K.y | Description | Qty. | Part Number |
|-----|--|------|-------------|
| 1 | Motor Kit | 1 | |
| | 12 VDC | | 30200-0000 |
| | 24VDC | | 30200-0010 |
| | 32VDC | | 30200-0020 |
| | 115VDC | | 30200-0050 |
| 2 | Blower Housing | 1 | 35744-0000 |
| 3 | Blower Wheel | 1 | 34742-0000 |
| 4 | Blower Housing | 1 | 35775-0000 |
| 5 | Screw 8 x 5/8 55 Self Tapping Pan Head | 5 | 35508-0000 |

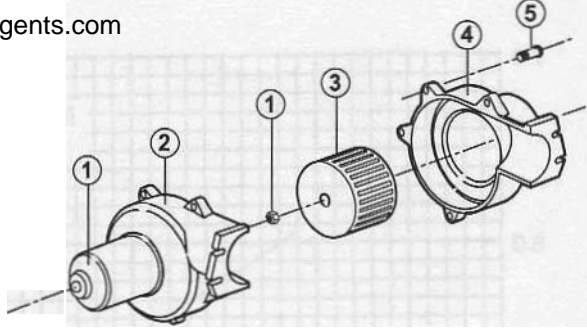

DIMENSIONAL DRAWING
Inches (Millimeters)

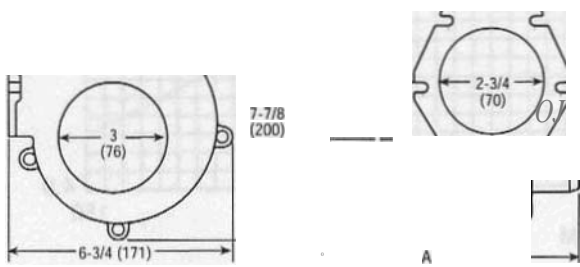

| Model | Dimension A |
|------------|--------------|
| 34739-0010 | 7-7/8" (200) |
| 34739-0020 | 7-7/8" (200) |
| 34739.Q031 | 8-3/8" (213) |

MARINE SWITCH PANELS

These rocker switch panels are available in an attractive black textured finish. Select between two models with or without illumination. All lighted models are complete with silicon seal boot.

44960-0002 and 44960-0003 include durable stick-on labels for all popular screws.

| Model | # Position | Elec. Rating |
|------------|-----------------------|-------------------------------------|
| 44960-0002 | 2 (on, off lighted) | 10 amps/12 Vdc |
| 44960-0003 | 2 (on, off unlighted) | 10 amps.6-32 Vdc 10 amps/110 Vdc |

MARINE SWITCH PANELS



44960-0002
Lighted Switch with Boot
SPST

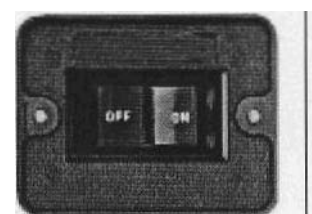

44960-0003
Unlighted SPST

Jabsco



ITT Industries
Engineered for life

THE PRODUCTS DESCRIBED HEREIN ARE
SUBJECT TO THE JABSCO ONE YEAR LIMITED
WARRANTY, WHICH IS AVAILABLE FOR YOUR
INSPECTION UPON REQUEST.

U.S.A
Jabsco
1485 Dale Way, P.O. Box 2158
Costa Mesa, CA 92628-21511
Tel: 714.545.8251
Fax: 714.957.0609

UNITED KINGDOM
Jabsco
Bingley Road, Hoddesdon
Hertfordshire EN11 0BU
Tel: +44 (0) 1992 450145
Fax: +44 (0) 1992 450150

CANADA
Fluid Products Canada
55 Royal Road
Guelph, Ontario N1H 1T1
Tel: (519) 821.1900
Fax: (519) 821.2500

JAPAN
NHK **Jabsco Company Ltd.**
3-21-10, Shin-Yokohama
Kohoku-Ku, Yokohama, 222
Tel: 045.475.8906
Fax: 045.475.8907

GERMANY
Jabsco GmbH
Oststrasse 28
22840 Norderstedt
Tel: +49-40-53 53 73-0
Fax: +49-40-53 53 73-11

For technical advice or service please take your pump into your local pump service center.
To order pump or parts or for pricing please go to the following links :

[Jabsco Pumps Home >>](#)

[Jabsco Pumps stock list >>](#)