

TCGP-76

| 1 - MOTORS                         |             |       |
|------------------------------------|-------------|-------|
| RPM & PHASE                        | PART NUMBER | HP    |
| <b>1725 RPM - OPEN DRIP PROOF</b>  |             |       |
| 1725 RPM<br>Single Phase<br>(ODP)  | 09797       | 1/3   |
|                                    | 09799       | 1/2   |
| 1725 RPM<br>Three Phase<br>(ODP)   | 09798       | 1/3   |
|                                    | 09800       | 1/2   |
| <b>3450 RPM - OPEN DRIP PROOF</b>  |             |       |
| 3450 RPM<br>Single Phase<br>(ODP)  | 09805       | 1     |
|                                    | 09807       | 1-1/2 |
|                                    | 09809       | 2     |
| 3450 RPM<br>Three Phase<br>(ODP)   | 09806       | 1     |
|                                    | 09808       | 1-1/2 |
|                                    | 09810       | 2     |
|                                    | 09812       | 3     |
|                                    | 09855       | 5     |
| <b>3450 RPM - TOTALLY ENCLOSED</b> |             |       |
| 3450 RPM<br>Three Phase<br>(TEFC)  | 09824       | 1-1/2 |
|                                    | 09845       | 2     |
|                                    | 09846       | 3     |

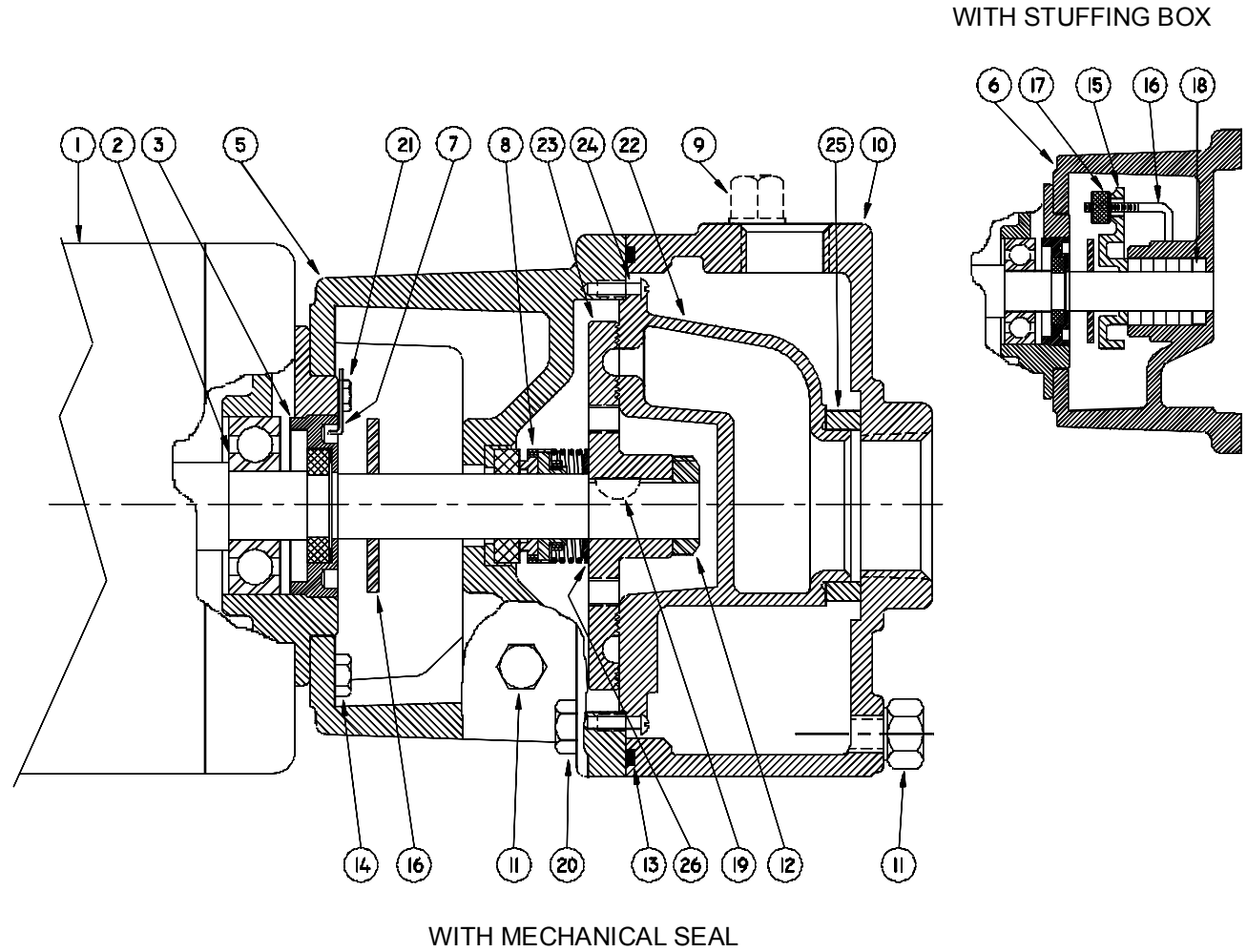

**SERIES: CS - CLOSE COUPLED TURBINE PUMPS**

File: CS.dwg

| SYMBOL NUMBER | PART NUMBER | QUANTITY | DESCRIPTION                                 |
|---------------|-------------|----------|---|
| 2             | 09144       | 1        | Ball Bearing - Pump End                     |
|               | 05290       | 1        | Ball Bearing - Switch End (Not Shown)       |
| 3             | 04206-A     | 1        | Screw, Impeller Adjusting                   |
| 4             | 08324       | 1        | Slinger Washer                              |
| 5             | 09787       | 1        | Frame (for mechanical seal)                 |
| 6             | 09792       | 1        | Frame (for stuffing box)                    |
| 7             | 07576       | 1        | Adjusting Screw Lock                        |
| 8             | 08991       | 1        | Mechanical Seal - Buna N                    |
|               | 09813-C     | 1        | Mechanical Seal - Viton                     |
|               | 21934       | 1        | Mechanical Seal - EPT                       |
| 9             | 02953       | 1        | Plug, 1/2"                                  |
| 10            | 09790-B     | 1        | Case  |
| 11            | 04236       | 2        | Plug, 1/4-18 NPT                            |
| 12            | 01404       | 1        | Impeller Lock Nut                           |
| 13            | 09791       | 1        | O-Ring Gasket - Buna N                      |
|               | 09817       | 1        | O-Ring Gasket - Viton                       |
|               | 22135       | 1        | O-Ring Gasket - EPT                         |
|               | 22104       | 1        | O-Ring Gasket - Teflon                      |
| 14            | 03121       | 4        | Screw, 1/4" x 3/4"                          |
| 15            | 05812-B     | 1        | Gland, Stuffing Box                         |
| 16            | 07003       | 2        | Gland Bolt                                  |
| 17            | 04211       | 2        | Gland Nut                                   |
| 18            | 05468       | 5        | Packing                                     |
| 19            | 01457       | 1        | Key, Woodruff (As Shown) (Repair Kits Only) |
|               | 21748-A     | 1        | Key, Square                                 |
| 20            | 01931       | 4        | Screw, 7/16-14 x 1-1/4" Lg                  |
| 21            | 07577       | 1        | Screw, #10 x 3/8" Lg                        |
| 22            | 09789-5     | 1        | Raceway for CS5M                            |
|               | 09789-6     | 1        | Raceway for CS6M                            |
|               | 09789-7     | 1        | Raceway for CS7M                            |
|               | 09789-8     | 1        | Raceway for CS8M                            |
|               | 09789-9     | 1        | Raceway for CS9M                            |

| SYMBOL NUMBER                                      | PART NUMBER  | QUANTITY | DESCRIPTION                       |
|--|--------------|----------|-----------------------------------|
| * 23   | SA09788-5    | 1        | Impeller for CS5M                 |
|  | SA09788-6    | 1        | Impeller for CS6M                 |
|  | SA09788-7    | 1        | Impeller for CS7M                 |
|  | SA09788-HT-8 | 1        | Impeller for CS8M                 |
|  | SA09788-HT-9 | 1        | Impeller for CS9M                 |
| 24   | 02535        | 2        | Screw, Raceway to Frame           |
| 25   | 04231        | 1        | Suction Sleeve - Buna N (std)     |
|  | 09695        | 1        | Suction Sleeve - Viton            |
|  | 20285        | 1        | Suction Sleeve - EPT              |
| <b>DIFFERING PARTS FOR ALL BRONZE CONSTRUCTION</b> |              |          |                                   |
| 5  | 09787-A      | 1        | Frame (for mechanical seal)       |
| 6  | 09792-A      | 1        | Frame (for stuffing box)          |
| 10   | 09790-C      | 1        | Case                              |
| 14   | 03121-B      | 4        | Screw, 1/4 x 3/4" Lg              |
| 20   | 08771        | 4        | Screw, 7/16-14 x 1-1/4" Lg., S.S. |

| <b>REPAIR KITS for CT SERIES PUMPS</b> |              |
|--|--------------|
| CATALOG NO.                            | FOR USE WITH |
| 20522-5                                | CS5M         |
| 20522-6                                | CS6M         |
| 20522-7                                | CS7M         |
| 20522-8                                | CS8M         |
| 20522-9                                | CS9M         |

Kit Includes: Impeller, Raceway, Shaft Seal, O-Ring Gasket, Suction Sleeve, Raceway Screws, Impeller Locknut, Shaft Key and instructions.

**PumpAgents.com**  
Wholesale Pump Agents

TCPP-77

SERIES: CS - CLOSE COUPLED TURBINE PUMPS

\* Standard impellers are suitable for fluid temperatures to 250°F. For higher temperatures, add the designation "HT" to impeller part number.

This includes all "MJ" Jacketed Seal Pumps.

Example: SA-9788HT-5